



Diamond Tools and Equipment



2016 Product Catalog

icsdiamondtools.com

FORCE4® & SealPRO Technology

Concrete cutting pros like you depend on your tools. All day, every day. Under the toughest conditions. You're the reason we invested four years developing the FORCE4® system, the strongest, longest-lasting diamond chain available. The precision and versatility you've come to expect from ICS in addition to the perfect blend of power and efficiency. The patented design better distributes the load, has 50% greater tensile strength than standard chains, and delivers the ideal combination of weight and strength to ensure a smooth cut and a long life. And the FORCE4 system with micro o-rings protecting every rivet joint, SealPRO keeps out the harsh abrasives in slurry that can cause chain stretch. SealPRO lessens water requirements and reduces chain tensioning.

A cutting revolution four years in the making Force4 diamond chain system with SealPRO technology is available for hydraulic, pneumatic, gas and now electric with the Pentruder High Frequency chain saw.

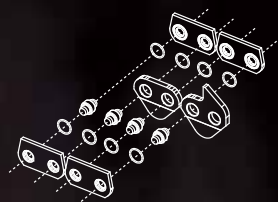



ICS[®]

Diamond Tools and Equipment

Table of Contents



Concrete Cutting Solutions

ICS Gas Power Saws	6-7
ICS Hydraulic Power Saws.....	8-9
ICS Pneumatic Power Saw	9

ICS Success Stories

Bridging the Gap	10
Saving the Past.....	11

Pipe Cutting Solutions

The PowerGrit Advantage.....	12
ICS PowerGrit Gas Saws & Chain	13-14
ICS PowerGrit Hydraulic Saws & Chain	15

ICS Diamond Tools & Accessories

ICS Diamond Chains.....	16-17
Accessories.....	18-19
Diamond Blades	20
Pentrunder Wall Saws.....	21 - 23
Pentrunder Wire Saw.....	24
Diamond Wire & Accessories.....	25
Pentrunder High Frequency Chain Saw.....	26
Pentrunder Accessories.....	27

FAQ's, Information & Part Numbers

Information.....	28
FAQ's.....	29
Part Numbers.....	30 - 31

ICS | Blount, Inc • 4909 SE International Way • Portland OR 97222 • USA • T 800.321.1240 • F 503.653.4393

Copyright 2016 ICS|Blount Inc. Pricing and specifications subject to change without notice. All rights reserved. ICS, EuroMAX, FORCE4, PowerGRIT, WallWalker, SpeedHook and SealPro are registered trademarks of ICS. The best way to cut concrete, DCT, TSS, TwinPRO, and ProFORCE are trademarks of ICS. 1116



Precision. Power. Performance. Safety.

ICS® is on a mission to help you get the job done faster and easier than you ever thought possible. For more than 25 years, our innovations in diamond tools and equipment have revolutionized concrete cutting — changing the way you work.

Patented ICS diamond chains, diamond blades, wire and core bits, and Pentrunder® saws, satisfy a full-range of infrastructure and construction applications. Your job demands power and precision. ICS provides tough, professional-quality tools that help you do it right. Deep plunge cuts, tight radiuses, clean square corners, concrete pipe taps and more; you're only limited by your idea of what's possible. And with end-to-end service from committed experts, you get the peace of mind to focus on what you do best.

Headquartered in Portland, Oregon, ICS also has a sales and distribution office in Belgium and a worldwide sales and service network covering more than 70 countries. ICS concrete chain saws, diamond chains, and related products are sold and supported by a network of ICS Authorized Dealers and backed by a comprehensive network of factory-trained personnel and service centers.



Diamond Tools and Equipment

ICS Gas Powered Saws

NEW



ALSO WORKS WITH
POWERGRIT® UTILITY SAW CHAIN
SEE PAGE 14

Features & Benefits **695XL-F4**

- Lower engine temperature with new piston & cylinder
- Longer life muffler with reinforced internal baffle
- Easy to start with higher energy ignition system
- New easy-to-tune carburetor

PART NUMBER	DESCRIPTION
575826	ICS 695XL F4 Powerhead
576151	ICS 695XL-12 F4 Gas Saw Package, with 12 in FORCE4 Guidebar & ProFORCE Chain
575872	ICS 695XL-16 F4 Gas Saw Package with 16 in FORCE4 Guidebar & ProFORCE Chain

695XL

Most versatile gas power saw for concrete and ductile iron

The new 695XL features include an easy to start engine with higher energy ignition system and durable, long-lasting components including a new muffler, carburetor and piston & cylinder. Available with 12-inch (30 cm) - 16-inch (40cm) guidebars and the entire line of MAX, ProForce™ and PowerGrit® series diamond chains. Based on the best-selling 695 saw platform, the 695XL is the highest horsepower ICS gas saw for frequent-use by general construction, utility contractors and concrete professionals.

TECHNICAL SPECIFICATIONS

Max Cutting Depth	16"
Bar length	up to 16 in/ (40cm)
Engine Speed	9300 +/- 150 rpm (max)
Idling Speed	2700 +/- 100 rpm
Horsepower	6.4 hp (4.8 kW) @ 9000 rpm
Engine Type	2-stroke, single cylinder, air cooled
Displacement	5.7 cu inch (94 cc)
Powerhead Dimensions	18"L x 14" H x 12" W (46 cm x 36 cm x 30 cm)
Guaranteed Sound Power Level, Lwa (1)	115 dB(A); (Kwa = 1.0 dB(A))
Sound Pressure Level, at Operator's Ear Lwa (1)	104.6 dB(A); (K = 1.0 dB(A))
Vibration, a hv, eq Concrete Cutting (2)	3.6 m/s ² (K=0.2 m/s ²) Front Handle 3.1 m/s ² (K=0.2 m/s ²) Rear Handle
Vibration, a hv, eq Pipe Cutting (2)	5.62 m/s ² (K=0.2 m/s ²) Front Handle 5.28 m/s ² (K=0.2 m/s ²) Rear Handle
Water Supply Requirement	Minimum of 20 psi (1.4 bar)
Water Flow Requirement	Minimum: 2 gpm (8 lpm)
Fuel Mix Ratio	50:1 (2%) fuel-to-oil
Fuel Capacity	0.26 gal (1.0 liter)

(1) Measured in accordance with ANSI S12.51-2012/ISO3741:2010

(2) Measured in accordance with ISO5349-1:2001, ISO22867:2011 and ISO19432:2012

NEW



ALSO WORKS WITH
POWERGRIT® UTILITY SAW CHAIN
SEE PAGE 14

695XL-GC

PART NUMBER	DESCRIPTION
581192	ICS 695XL GC Powerhead
576150	ICS 695XL-12 GC Gas Saw Package, with 12 in Guidebar & TwinMAX Chain
575863	ICS 695XL-14 GC Gas Saw Package, with 14 in Guidebar & TwinMAX Chain
575865	ICS 695XL-16 GC Gas Saw Package, with 16 in Guidebar & TwinMAX Chain



Solutions for Concrete, Masonry and Stone

NEW

ALSO WORKS WITH
POWERGRIT® UTILITY SAW CHAIN
SEE PAGE 13

680ES

Best value for cutting deep, square or irregular openings

Built to meet the operation and flexibility demands of the general construction user, the 680ES stands alone in terms of reliability and value. Easy to start with a new multifunction lever to control choke, run, and stop functions. The distinctive black powerhead houses specially designed carburetion and ignition systems that work together to ensure easy starting, cooler operation and dependable performance at just about any elevation. Available with 12-inch (30 cm) and 14-inch (35 cm) guidebars and the entire line of MAX series diamond chain. With a quick switch of the guidebar, chain and drive sprocket, the new 680ES can operate PowerGrit Utility Saw chain, designed to cut ductile iron pipe.



680ES

Features & Benefits

- Easy to control choke, run and stop functions
- Prevent engine flooding with new multifunction lever
- Simple to start
- Expert tool at an affordable price

PART NUMBER	DESCRIPTION
576155	ICS 680ES Powerhead
576154	ICS 680ES-12 GC Gas Saw Package, with 12 in Guidebar & TwinMax Chain
576153	ICS 680ES-14 GC Gas Saw Package, with 14 in Guidebar & TwinMax Chain

TECHNICAL SPECIFICATIONS

Max Cutting Depth	14"
Bar length	up to 14 in/(35cm)
Engine Speed	11500 +/- 500 rpm (max)
Idling Speed	2800-3200 rpm
Horsepower	5 hp (3.7 kW)
Engine Type	2-stroke, single cylinder, air cooled
Displacement	4.7 cu inch (76.5 cc)
Powerhead Dimensions	18"L x 11.5" H x 10" W (46 cm x 29 cm x 25 cm)
Guaranteed Sound Power Level, Lwa (1)	117 dB(A); (Kwa = 3.0 dB(A))
Sound Pressure Level, at Operator's Ear Lwa (1)	101.0 dB(A); (K = 2.0 dB(A))
Vibration, a _{hv} , eq Concrete Cutting (2)	7.2 m/s ² (K=1.0 m/s ²) Front Handle 8.5 m/s ² (K=1.0 m/s ²) Rear Handle
Water Supply Requirement	Minimum of 20 psi (1.4 bar)
Water Flow Requirement	Minimum: 2 gpm (8 lpm)
Fuel Mix Ratio	50:1 (2%) fuel-to-oil
Fuel Capacity	0.26 gal (0.88 liter)

(1) Measured in accordance with ANSI S12.51-2012/ISO3741:2010
(2) Measured in accordance with ISO5349-1:2001 and ISO22867:2011



ICS Hydraulic Powered Saws



890F4

Features & Benefits

- Most professional performance
- Optimum chain performance
- Easy starting
- Submersible

PART NUMBER	DESCRIPTION
566110	ICS 890F4 Powerhead 8 gpm, 1 ft hose whips
566355	ICS 890F4 Powerhead 8 gpm, 8 ft hose whips
566112	ICS 890F4 Powerhead 12 gpm, 1 ft hose whips
566116	ICS 890F4 Powerhead 12 gpm, 8 ft hose whips
566127	ICS 890F4-15 Saw Package 8 gpm with 15 inch Guidebar, ProFORCE chain, 1 ft hose whips, case
566717	ICS 890F4-15 Saw Package 8 gpm with 15 inch Guidebar, ProFORCE chain, 8 ft hose whips, case



890F4-FL Flush Cut Saw

Features & Benefits

- Cuts within 3/16" of a wall
- Optimum chain performance
- Most professional
- Easy starting
- Submersible

PART NUMBER	DESCRIPTION
566113	ICS 890F4-FL Powerhead 8 gpm, 1 ft hose whips
566351	ICS 890F4-FL Powerhead 8 gpm, 8 ft hose whips
566114	ICS 890F4-FL Powerhead 12 gpm, 1 ft hose whips
566117	ICS 890F4-FL Powerhead 12 gpm, 8 ft hose whips

890 Series

Over 20 years of ICS® product innovation and The ICS 890 Series hydraulic cutting system offers the superior strength of FORCE4® technology. From the redesigned, more durable rear handle, to the easy to replace drive sprocket, this saw is engineered to stand up to your toughest jobs. In a package that exceeds industry standards this sleek powerhouse is packed with features designed to make it work as hard as you do.

TECHNICAL SPECIFICATIONS

	8 GPM	12 GPM
Weight	27.3 lbs (12.4 kg) with 15-inch (38 cm) bar and chain	
Bar Length	Up to 25 inches (63 cm)	
Motor Speed	6100 rpm	6500 rpm
Powerhead Dimensions	23 inches (58.5 cm) Length 10.5 inches (26.5 cm) Height 9.5 inches (24 cm) Width	
Torque	122 in-lbs (13.8 Nm)	170 in-lbs (19.2 Nm)
Horsepower	11.5 hp (8.5 kW)	17.5 hp (13 kW)
Hydraulic Supply	8 gpm (30 lpm), 2500 psi (172.5 bar)	12 gpm (45 lpm), 2500 psi (172.5 bar)
Noise Level	107 dB @ 3 ft (1 m)	
Water Supply	Minimum 20 psi (1.5 bar)	

* product data shown is rated based on maximum input conditions and efficiency assumptions may vary dependent on power supply.



ICS Hydraulic & Pneumatic Saws



814PRO

Features & Benefits

- Lightweight
- Fits into small spaces
- Same power as the 890 Series saws

PART NUMBER	DESCRIPTION
75256	ICS 814PRO Powerhead 8 gpm
71675	ICS 814PRO Saw Package 8 gpm with 13 inch Guidebar & TwinPRO Diamond Chain

814PRO

It may be small but with as much power as the 890 series, the 814PRO is ready for the big jobs. Lighter than other hydraulic saws with the ability to cut perfectly square openings as small as 3.5 inches (9 cm), the 814PRO is a natural for utility work and other applications where a mix of portability and power are required.

TECHNICAL SPECIFICATIONS

Weight	15 lbs (6.8 kg) with 13-inch (32 cm) bar and chain
Bar Length	13 inches (32 cm)
Motor Speed	8800 rpm
Powerhead Dimensions	14.3 inches (36.3 cm) Length 11.3 inches (28.7 cm) Height 9.2 inches (23.4 cm) Width
Torque	84 in-lbs
Horsepower	11.5 hp (8.5 kW)
Hydraulic Supply	8 gpm (30 lpm), 2500 psi (172.5 bar)
Noise Level	88 dB @ 3 ft (1 m)
Water Supply	Minimum 20 psi (1.5 bar)

* product data shown is rated based on maximum input conditions and efficiency assumptions may vary dependent on power supply.

ICS Pneumatic Saws



701-A

Features & Benefits

- Durable die cast aluminum frame
- No fumes in trench
- Cut concrete and ductile iron
- Offers safe alternative to cutting with a circular saw

PART NUMBER	DESCRIPTION
573511	ICS 701-A Powerhead
574173	ICS 701-A Saw Package with 15 inch Guidebar & ProFORCE chain
574171	ICS 701-A Saw Package with 15" Guidebar & PowerGrit Chain
574172	ICS 701-A Saw Package with 20" Guidebar & PowerGrit Chain

701-A

Built tough to stand up to everyday use in the harsh environment of concrete cutting. Cut with ease, speed and portability through Reinforced Concrete, Brick, Block, Concrete Pipe, Ductile Iron, Cast Iron, PVC and Natural Stone. The ICS powerful air saw is designed to cut through walls, floors and columns in a single pass.

TECHNICAL SPECIFICATIONS

Weight (without bar and chain)	29 lbs (13 kg)
Powerhead Dimensions	20" L x 10.5" H x 12" W (58.5 cm x 26.5 cm x 30.5 cm)
Air Motor Power	6.5hp (5 kW)
Air Supply Requirements (maximum)	90 psi (6 bar) 124 cfm (3.5 m ³ /min)
Motor lubrication	Resin and acid-free SAE 5 W to SAE 10 W oil
Water Pressure Requirements	Minimum: 1.4 bar (20psi)
Water Flow Requirements	Minimum: 2 gpm (8 lpm)
Operating Speed	5,700 rpm (average free running) 4,900 sfm (average free running chain)
Vibration ahv, eq Concrete Cutting ⁽²⁾	Front handle: 5.09 m/s ² (K=0.2 m/s ²) Rear handle: 5.07 m/s ² (K=0.2 m/s ²)
Vibration ahv, eq PowerGrit Cutting ⁽²⁾	Front handle: 4.58 m/s ² (K=0.2 m/s ²) Rear handle: 4.43 m/s ² (K=0.2 m/s ²)
Guaranteed Sound Power Level Lwa (1)	113 dB(A); (Kwa=0.5 dB(A))

(1) Measured in accordance with ANSI S12.51-2012/ISO3741:2010

(2) Measured in accordance with ISO5349-1:2001 and ISO22867:2011

BRIDGING THE GAP

Rehabilitation Solution

The background:

When the historic Longfellow Bridge connecting Boston and Cambridge MA needed rehabilitation, a local Boston contractor partnered with ATS Equipment, a long time ICS® distributor to get the job done efficiently and accurately.

The challenge:

This bridge built in 1908 handles 28,000 vehicles per day along with 90,000 transit users on the MBTA Red Line and a large number of pedestrians and bicyclists. Several factors have contributed to the deterioration of the bridge including weather, pollution and increased traffic. Block openings needed to be cut in the 24" thick granite substructure to update the utilities that run below the bridge. The contractor's original equipment only cut 20" deep, which brought the work to a slow, agonizing crawl.

The solution:

ATS Equipment stepped in and provided the ICS® hydraulic power saw set up with 25" ProForce™ chains and P110 power pack. These tools allowed the contractor to cut all the way through the granite blocks from one side, with no overcuts, minimizing any additional damage to the historic structure.



The Results:

With the ICS saw, production immediately increased from three to nine openings per day. That's good news for the Massachusetts Department of Transportation and even better for the commuters who use that bridge daily.

SAVING THE PAST

Precision Required

The background:

Castle Drogo is located high above the Teign Valley with sweeping views of Dartmoor, England. Built in 1931 for a wealthy retail magnate, it can truly be regarded as Britain's last castle.

The challenge:

The lofty location of the castle allows for stunning photos and beautiful views, but has exposed the building to the legendarily tough weather. Due to the higher altitude and exposed nature of the landscape, climatic conditions are more extreme; generally warmer, wetter and windier than the rest of the country. These conditions have caused the roof and windows to leak and therefore need to be replaced in order to save this national treasure. The castle is protected by a conservation order, meaning none of the visual elements can be defaced or altered. This requires that the granite blocks remain intact when removed.

The solution:

The contractor needed to cut out granite blocks so repairs could be made in the voids of the stonework, making the building water tight. The blocks would then be replaced in their original positions. The initial method of stitch drilling was a solution, but a slow one. Each block took 3.5 hours to remove. This is where ICS stepped in to help. Using the hydraulic power saw and ProForce™ chain, they were able to cut around the mortar joint and pry out the block with pinch bars.



The Results:

The cutting time was reduced from 3.5 hours per block to 25 minutes. With the first phase of the project being to cut 250 linear meters (820 linear feet) at 30 cm (12 inches) deep, this saved days worth of time all while preserving the historical significance of this grand castle.

The ICS PowerGrit Advantage

PowerGrit® – Safer. Faster. Easier.

ICS® Utility saws have addressed operator safety with a revolutionary grinding technology which eliminates rotational kickback and offers improved operator positioning when cutting pipe. Utilized by water and wastewater departments worldwide, this patented platform, exclusively from ICS, is designed to cut a variety of materials from ductile iron to plastic pipe with far less excavation. The ability to cut up to 24" pipe completely from one side radically reduces the difficulty of the job. Complete your next job safer, faster and easier with ICS Utility chain saws.

Features & Benefits

- No rotational kickback
- Single-point access
- Operator control
- Safer operation
- No flying debris or dust

Cutting Applications

- Ductile Iron Pipe
- Cast Iron Pipe
- PVC Pipe
- HDPE Pipe
- Insituform Pipe Lining
- Asbestos* Cement Pipe

ICS PowerGrit Method Versus Conventional Method

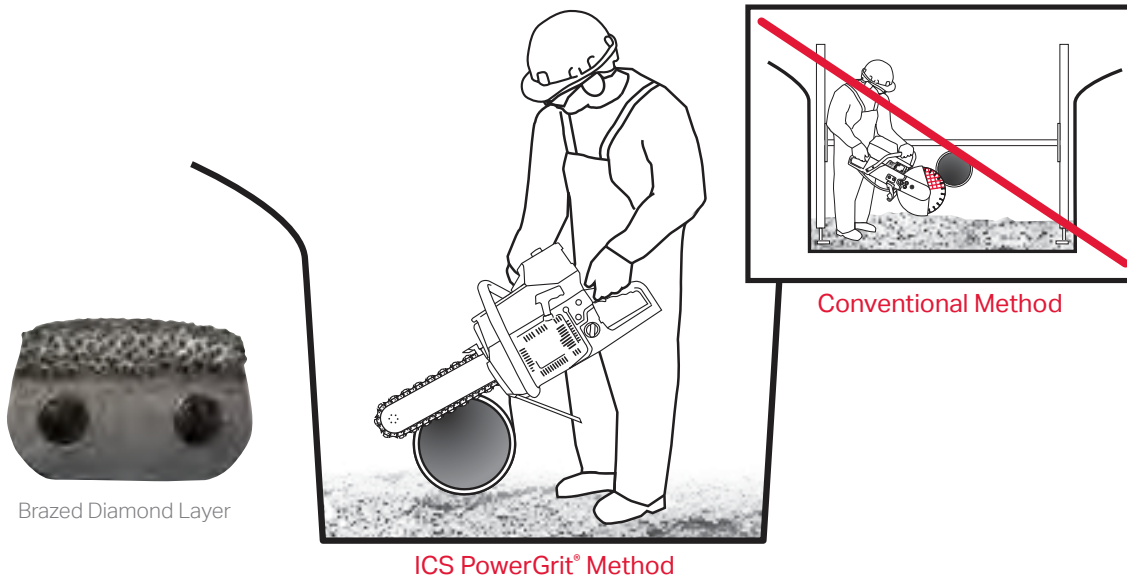

ICS PowerGrit Method

- Cutting depth up to 24" (61 cm)
- No rotational kickback
- Gyroscopic motion eliminated
- Chain stops quickly after throttle is released
- Direct drive sprocket eliminates slippage
- Cutting depth allows for single side access
- Reduced excavation below the pipe, may eliminate the need for shoring

Conventional Method

- Cutting depth of only 4-5 inches (10 - 12 cm)
- Operator exposed to potential rotational kickback
- Gyroscopic motion reduces saw control
- Blade continues turning after throttle is released
- Excess excavation needed to cut below the pipe
- Access to both sides of pipe is required
- Guard positioning compromises operator safety

Not all cities, municipalities, townships, and governments follow the same laws. Be sure to adhere to local guidelines and regulations when operating our products.

* Asbestos is a hazardous material, known to cause serious respiratory diseases. Cutting into asbestos can release asbestos fibers into the air. Always research and follow the correct safety procedures, including applicable national and state or provisional occupational health and safety regulations, and protect yourself and those around you from asbestos-related disease. Always arrange for the material to be removed safely by a qualified person. ICS is not responsible for exposure to asbestos caused by use of this product.

Solutions for Utility Pipe

NEW

ALSO CUTS CONCRETE, STONE,
MASONRY & BRICK.

SEE PAGE 7



680ES-PG

680ES-PG

Built to provide a combination of performance and portability for cutting in-ground utility pipe, the 680ES-PG gas powered utility chain saw with PowerGrit® chain will change the way you cut pipe. This affordably priced gas powered saw, allows you to cut up to 10" deep from one side into ductile iron, cast iron, PVC, HDPE, Insituform lining and even Asbestos*concrete pipe, and is also designed to run the full line of MAX series chains. With a quick switch of guidebar, chain and drive sprocket, you have the ability to use this saw in masonry, stone, and even reinforced concrete. Making it the most cost effective, versatile tool in your arsenal.

Features & Benefits

- Lightweight powerhead
- Simple to start
- New multifunction lever
- Easy to control choke



TECHNICAL SPECIFICATIONS

Max Cutting Depth	10"
Bar length	up to 14 in(35cm)
Engine Speed	11500 +/- 500 rpm (max)
Idling Speed	2800-3200 rpm
Horsepower	5 hp (3.7 kW)
Engine Type	2-stroke, single cylinder, air cooled
Displacement	4.7 cu inch (76.5 cc)
Powerhead Dimensions	18"L x 11.5" H x 10" W (46 cm x 29 cm x 25 cm)
Guaranteed Sound Power Level, Lwa (1)	117 dB(A); (Kwa = 3.0 dB(A))
Sound Pressure Level, at Operator's Ear Lwa (1)	101.0 dB(A); (K = 2.0 dB(A))
Vibration, a hv, eq Concrete Cutting (2)	7.2 m/s ² (K=1.0 m/s ²) Front Handle 8.5 m/s ² (K=1.0 m/s ²) Rear Handle
Water Supply Requirement	Minimum of 20 psi (1.4 bar)
Water Flow Requirement	Minimum: 2 gpm (8 lpm)
Fuel Mix Ratio	50:1 (2%) fuel-to-oil
Fuel Capacity	0.26 gal (0.88 liter)

(1) Measured in accordance with ANSI S12.51-2012/ISO3741:2010
(2) Measured in accordance with ISO5349-1:2001 and ISO22867:2011

PART NUMBER	DESCRIPTION
576155	ICS 680ES Powerhead
580423	ICS 680ES PG-10 gas saw package with 10" PowerGrit guidebar and Powergrit chain

The ICS PowerGrit Advantage

NEW

ALSO CUTS CONCRETE, STONE,
BRICK & MASONRY

SEE PAGE 6



695XL-PG

Features & Benefits

- Longer chain life with Force4® Technology
- Ultimate versatility and power
- Also operates ProFORCE™ chain
- Highest horsepower for ductile iron

PART NUMBER	DESCRIPTION
575826	ICS 695XL F4 Powerhead
575827	ICS 695XL-16 PG Gas Saw Package with 16 inch FORCE4 Guidebar and PowerGrit chain

695XL-PG

Gas-Powered Utility Chain Saw

Built to provide the best combination of performance and portability for cutting in-ground utility pipe, the 695XL-PG Gas-Powered Utility Chain Saw with PowerGrit® chain will change the way you cut pipe. The 695XL-PG offers an unmatched power to weight ratio, allowing you to cut up to 16" deep from one side into ductile iron, cast iron, PVC, HDPE, and Insituform lining. Also the 695XL-PG is capable of operating the full line of 16" ProFORCE™ concrete cutting chains, meaning you can use the saw on masonry, stone, and even reinforced concrete - perfect for pipe taps, utility vaults, bridge work, and other utility applications.

TECHNICAL SPECIFICATIONS

Weight	21 lbs/9.6 kg (without bar and chain)
Bar Length	Up to 16" (40 cm)
Engine Speed	11500 +/- 500 rpm, 2500-2800 rpm idle
Powerhead Dimensions	19 inches (48 cm) Length 14 inches (36 cm) Height 12 inches (30 cm) Width
Horsepower	6.4 @ 9000 rpm
Engine Type	2-stroke, single cylinder, air cooled
Displacement	5.7 cu. inch (94 cc)
Fuel Mix Ratio	50:1 (2%) fuel-to-oil)
Water Supply	Minimum of 20 psi (1.5 bar)



Solutions for Utility Pipe

ALSO CUTS CONCRETE, STONE,
BRICK & MASONRY
SEE PAGE 8



890PG

890PG

Hydraulic-Powered Utility Chain Saw

If you're looking for the highest level of performance and cutting capability, look no further. The 890PG Hydraulic-Powered Utility Chain Saw offers cutting depths up to 25" in ductile iron, cast iron, PVC, HDPE, and Insituform lining. The deep cutting ability of the 890PG with PowerGrit® utility chain, allows the operator to make a single cut from one side meaning less excavation is required. The 890PG is also capable of operating the full-line of 890F4 ProFORCE™ concrete cutting chains, meaning you can use the saw on masonry, stone, and even reinforced concrete - perfect for pipe taps, utility vaults, bridge work, and other utility applications.

Features & Benefits

- Also operates ProFORCE™ diamond chain
- Increased safety
- Better operator control
- Reduced excavation
- Versatility

PART NUMBER	DESCRIPTION
566123	ICS 890PG-15 Saw Package 8 gpm, 15 inch Guidebar, PowerGrit chain, 1 ft hose whips, case
566710	ICS 890PG-15 Saw Package 8 gpm, 15 inch Guidebar, PowerGrit chain, 8 ft hose whips, case
566125	ICS 890PG-15 Saw Package 12 gpm, 15 inch Guidebar, PowerGrit chain, 1 ft hose whips, case
566712	ICS 890PG-15 Saw Package 12 gpm, 15 inch Guidebar, PowerGrit chain, 8 ft hose whips, case
566124	ICS 890PG-20 Saw Package 8 gpm, 20 inch Guidebar, PowerGrit chain, 1 ft hose whips, case
566711	ICS 890PG-20 Saw Package 8 gpm, 20 inch Guidebar, PowerGrit chain, 8 ft hose whips, case
566126	ICS 890PG-20 Saw Package 12 gpm, 20 inch Guidebar, PowerGrit chain, 1 ft hose whips, case
566716	ICS 890PG-20 Saw Package 12 gpm, 20 inch Guidebar, PowerGrit chain, 8 ft hose whips, case

TECHNICAL SPECIFICATIONS

	8 GPM	12 GPM
Weight	27.3 lbs (12.4 kg) with 15-inch (38 cm) bar and chain	
Bar Length	Up to 25 inches (63 cm)	
Motor Speed	6100 rpm	6500 rpm
Powerhead Dimensions	23 inches (58.5 cm) Length 10.5 inches (26.5 cm) Height 9.5 inches (24 cm) Width	
Torque	122 in-lbs (13.8 Nm)	170 in-lbs (19.2 Nm)
Horsepower	11.5 hp (8.5 kW)	17.5 hp (13 kW)
Hydraulic Supply	8 gpm (30 lpm), 2500 psi (172.5 bar)	12 gpm (45 lpm), 2500 psi (172.5 bar)
Noise Level	107 dB @ 3 ft (1 m)	
Water Supply	Minimum 20 psi (1.5 bar)	

* product data shown is rated based on maximum input conditions and efficiency assumptions may vary dependent on power supply.



ICS Diamond Chain

Diamond Chain Technology

Diamond chains are not all created equal, so insist on Diamond Chains from ICS®, the people who invented the technology. As the inventors of Diamond Chain Technology™, ICS is committed to continually improving the quality and versatility as well as the perfect blend of power, precision and efficiency: chains specifically designed for different saw types as well as the many different materials you encounter on the job. Choosing the right chain for your needs is essential to getting the best value for your purchase.

FORCE4® Series Diamond Chain

- Strongest, most durable, patented chain design
- Laser welded diamond segments
- Contains SealPRO O-ring technology for longer life
- Designed for heavy, professional use

MAX Series Diamond Chain

- Segments designed for general use
- Laser welded to patented chain chassis
- Contains patented SealPRO® O-ring technology for longer life
- Segment types for general and specialty applications

PowerGrit® Utility Chain

- Single brazed diamond layer
- Patented cutter design
- Available for gas, hydraulic and pneumatic
- Utilizes FORCE4 chassis for maximum durability

Chain Selection Chart

Chain Applications	Saw	Soft Stone/ Abrasive/Brick	Natural Stone	Medium Concrete/ Light Reinforcement	Hard Concrete/ Heavy Reinforcement	Ductile Iron/Cast Iron/PVC/HDPE
TwinMAX™ General Purpose	695ES GC 695XL GC		♦	♦		
TwinMAX™ Plus For harder materials	695ES GC 695XL GC		♦	♦	♦	
TwinMAX™ Abrasive Ideal for brick & block	695ES GC 695XL GC	♦				
TwinPro™ General Purpose	814PRO		♦	♦	♦	
ProFORCE™ General Purpose	890 Series 695XL F4		♦	♦	♦	
ProFORCE™ L Longer Cutting life	890 Series 695XL F4		♦	♦	♦	
ProFORCE™ S Faster cutting speed	890 Series 695XL F4			♦	♦	
ProFORCE™ Abrasive Ideal for brick & block	890 Series 695XL F4	♦				
PowerGrit For Utility Pipe	890 Series 695XL PG 680ES PG					♦



Diamond Chain with SealPRO® Technology

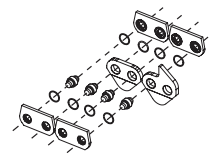

Revolutionary SealPRO Diamond Chain from ICS is a true design breakthrough that reduces chain stretch by 50% or more, potentially giving you more life out of your diamond chain, even in the most abrasive applications and in situations where water is a premium. SealPro technology is based on a patented design with micro O-rings inserted around every rivet, on every link, sealing out abrasive materials that cause chain stretch.



FORCE4® Diamond Chain

From the company that revolutionized concrete saws comes a revolution in diamond chains: FORCE4®. Designed to be the strongest, longest lasting diamond chains ever made, the ProFORCE™ series delivers unrivaled performance in professional cutting applications.

ProFORCE™

Tough general purpose diamond chains that excel in common cutting jobs.

ProFORCE™ Premium L

Delivering longer life in hard aggregate, this is the best choice when faced with the more demanding jobs.

ProFORCE™ Premium S

Speed and strength in one chain. Built to cut fast in medium to hard concrete.

ProFORCE™ Abrasive

A heavy duty diamond chain that excels in the harshest, most abrasive cutting environments.



Max Series Diamond Chain

Designed to be used with the full line of ICS gas powered chain saws (except 695XL F4), these chains offer the ultimate combination of versatility and affordability. Named for the patented double-bumper design, TwinMAX™ chains feature smooth cutting performance and easy installation.

TwinMax™

A good general purpose chain that will handle most of cutting jobs.

TwinMax™ Plus

Built to tackle harder materials and more steel, TwinMAX™ Plus is a long-lasting general purpose diamond chain.

TwinMax™ Abrasive

A special diamond concentration and harder bond make this diamond chain perfect for cutting through highly abrasive aggregate like brick and sandstone.



PowerGrit® Utility Diamond Chain

Utilized by public and private water and wastewater departments worldwide, this patented platform exclusively from ICS is designed to cut a variety of materials from ductile iron to plastic pipe. Featuring a brazed layer diamond coating on our FORCE4 platform, this chain makes your job safer, faster and easier.

ICS Accessories



Portable Hydraulic Powerpack

ICS® gas powered powerpacks are a dependable, self-contained source of hydraulic power that offer superior cooling capacity. The functional, ergonomic design makes them easily transportable to any job site.

P95 18 hp (13.5 kW) Powerpack

Affordable hydraulic power with exceptional cooling capability in an easy to carry package. Adjustable for 5 gpm or 8 gpm (20 lpm or 30 lpm) operation.

P110 23 HP (17 kW) Powerpack

Step up to the power of the most powerful line of reliable powerpacks. Adjustable to 8 gpm or 12 gpm (30 lpm or 45 lpm) operation.

PART NUMBER	DESCRIPTION
550888	P95 18 hp (13.5 kW) Powerpack
555090	P110 23 HP (17 kW) Powerpack

Portable Water Supply

When water isn't readily available, this corrosion resistant water supply system, with poly tank provides the solution. Able to hold up to 25 gallons, this system offers the pressure and flow that ICS saws require. The High-Flo pump provides 1.8 gpm at 60 psi and comes with alligator clips for 12v battery hookup. Comes with a whip fitted with a standard hose end, ready for any regular hose.



PART NUMBER	DESCRIPTION
573285	Portable Water Supply



890F4/701-A Pipe Clamp

In addition to the time saving value of PowerGrit® technology, the pipe clamp accessory developed for the underground pipe application brings a whole new level of safety, accuracy and ease of use to the job. With a simple adaptor, you can mount to this clamp and dramatically reduce the effort of handling the saw, while providing a solid, stable cutting platform that also improves operator safety and the precision of the cut.

FOR 890F4/701-A ONLY

PART NUMBER	DESCRIPTION
537640	Pipe Clamp
537634	Axle replacement

Flow Adapter Valve

Enjoy the convenience and efficiency of powering your ICS® hydraulic saw from skid steers, backhoes, and other common construction equipment. Available for both 8 gpm and 12 gpm (30 lpm and 45 lpm) saws.

PART NUMBER	DESCRIPTION
70350	8 gpm Flow adapter valve
71287	12 gpm Flow adapter valve



Hydraulic Hoses

Quick disconnect, 25' long, 3000psi.

PART NUMBER	DESCRIPTION
70466	25' hoses



TSS™ Vacuum Systems

The Total Slurry Solutions provide an easy way to contain and dispose of slurry produced when wet-sawing or drilling in concrete, stone, or masonry. All TSS systems come with 15 feet (4.6 m) of heavy duty professional grade vacuum hose.

TSS-15

The TSS-15 features an extremely durable electric powerhead mounted on a dent and corrosion resistant polyethylene tank. An oversize "boat-plug" style drain plug makes emptying the 15-gallon (55 liter) tank fast and easy and heavy-duty wheels and casters make moving the TSS™-15 effortless.

TSS 55

Turn any standard 55-gallon drum into a slurry containment system. The TSS 55 seals to the top with external fasteners or modification, providing 105 inches (267 cm) of water lift.



PART NUMBER	DESCRIPTION
73862	TSS-15 Vacuum system
71285	TSS-55 Vacuum system

SpeedHook®

SpeedHook® is an ingenious accessory designed to support the weight of ICS® hydraulic saws, dramatically reducing operator fatigue and extending chain life.

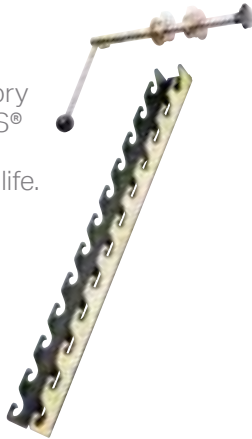

PART NUMBER	DESCRIPTION
528551	SpeedHook System includes 42 inch (1 m) rail & mounting bracket

ICS® 2-Stroke Oil

Intensive laboratory and field testing have resulted in an oil formula that is cleaner burning, provides better thermal protection and an improved film barrier reducing piston ring wear. Protect your investment with work-proven ICS® 2-stroke Engine Oil.



PART NUMBER	DESCRIPTION
571227	2.6 oz (77 ml) 6-pack
571228	2.6 oz (77 ml) 24-pack

Replacement Parts

Visit your local dealer or see our website icsdiamondtools.com/customer-service-support/ for a complete listing of available parts.

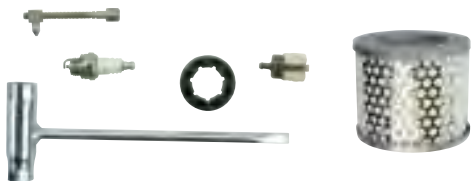

ICS® Large Carry Case

Fits 880, 890 and 853PRO series.

PART NUMBER 71772







ICS ProForce Diamond Blades

ProForce Diamond Blades

Constructed and expertly engineered, our diamond blades are some of the best in the industry. Designed to handle a wide variety of concrete-cutting situations that professional cutters experience, ICS® ProFORCE™ blades are built to the highest of quality standards and made to last. Available in a variety of bolt patterns and sizes to fit almost any saw. No matter the harsh conditions, the ProFORCE line has a blade for you. Available to the ProUser market only. To find an ICS sales representative in your area, please call 800.321.1240.

AGGREGATE HARDNESS

		SOFT	SOFT/MEDIUM	MEDIUM	MEDIUM/HARD	HARD
	CURED					
	ProFORCE EC 110F			LOW HP	HIGH HP	
	ProFORCE PLUS CP 120F			LOW HP		HIGH HP
	ProForce CP 134F		LOW HP		HIGH HP	
	ProFORCE PLUS CP 145F	LOW HP		HIGH HP		
	ASPHALT					
	ProFORCE A 400F			LOW HP	HIGH HP	
	ProFORCE PLUS A 450F	LOW HP		HIGH HP		
	GREEN					
	ProFORCE PLUS G 300F			LOW HP	HIGH HP	
	ProFORCE G 400F			LOW HP	HIGH HP	
	ProFORCE PLUS G 400F		LOW HP		HIGH HP	
	ProFORCE PLUS G 450F	LOW HP		HIGH HP		
	HAND SAW					
	ProFORCE HS 20			LOW HP	HIGH HP	
	ProFORCE HS 60		LOW HP		HIGH HP	
	ProFORCE HS 110	LOW HP		HIGH HP		
	WALL SAW					
	ProFORCE WS 20				LOW HP	HIGH HP
	ProFORCE WS 110			LOW HP	HIGH HP	
	ProFORCE PLUS WS 122	LOW HP		HIGH HP		

To learn more about our Diamond Blades, Core Bits and Accessories, please visit our website: icsdiamondtools.co/diamond-blades-core-bits-wire/

Pentrunder products provide the most powerful cutting, sawing, and drilling solutions for unparalleled productivity. Pentrunder users make the straightest lines and openings in the toughest materials because Pentrunder tools feature rigid construction, finely tuned motors, and countless construction details. If you are using a Pentrunder product now, you know how much more you can do in a day. If you have not yet tried Pentrunder, do you know what you're missing?



6-10 HF Wall Saw

This powerful wall saw is the lightest weight sawhead from Pentrunder, and provides the exceptional horsepower expected of a Pentrunder wall saw.

The 6-10 sawhead, 20 hp motor, and 24 hp motor components are also available individually for customers that want to add a lighter weight configuration to their existing Pentrunder system. Please note adding this may require a software update to the PentPak. Ask your ICS sales representative for details.

FEATURES AND BENEFITS

- Lightest weight Pentrunder wall saw system
- Easy job setup with versatile, lightweight track system
- Expandable Pentrunder Modular Concrete Cutting System

TECHNICAL SPECIFICATIONS

Saw Blade Diameter max	42 in (107 cm)
Max Cutting Depth	18 in (46 cm)
Max start blade	30 in (76 cm)
Saw blade motor	400 Hz High Frequency Motor
Max continuous output power	15 kW (20 hp) / 18 kW (24 hp)
Spindle speed under load	815 – 1200 rpm
Minimum fuse	16 Amp
Saw head weight	44 lbs (20 kg)
Weight - 15 kW HF-motor	29 lbs (13 kg)
Weight - 18 kW HF-motor	36 lbs (16 kg)



8-20 HF Wall Saw

With its high performance HF-motor and the quick disconnect blade coupling, the Pentrunder 8-20 HF Wall Saw does the most demanding jobs more efficiently. Thanks to the 4-speed gearbox, this saw will work with remarkably high torque at all spindle speeds. Engineered to deliver dependable, lightweight, reliable power, this saw is ideal for anyone who is a professional cutter.

TECHNICAL SPECIFICATIONS

Maximum blade diameter	79 inches
Maximum cutting depth	36 inches
Maximum out-of-cut diameter	39 inches
Saw blade motor (30 HP HF-motor)	400 Hz High Frequency Motor
Max continuous output power	30 HP with Pentpak 427
Spindle speed under load	1st gear: 350 - 510 rpm 2nd gear: 500 - 735 rpm 3rd gear: 630 - 925 rpm 4th gear: 790 - 1165 rpm, @ 300 - 440 Hz
Saw head weight	56 lbs
Weight (30 HP HF-motor)	40 lbs

FEATURES AND BENEFITS

- Most popular Pentrunder saw
- Powerful - cut up to 36 inches deep in concrete
- Precise because of rigid aluminum construction
- Portable with each component less than 60lbs



8-20HF Wall Saw
4-speed Gear Box

High torque at all spindle speeds because of 4-speed gearbox and software controls



CBK HF Wall Saw

With its high performance HF-motor and the quick disconnect blade coupling, the Pentrunder CBK is an extremely user-friendly saw. The spindle speed is electronically varied with the potentiometer and the saw handles blades up to 63". This saw offers a combination of easy handling and a good power-to-weight ratio.

TECHNICAL SPECIFICATIONS

Maximum blade diameter	63 inches
Maximum cutting depth	28 inches
Maximum out-of-cut diameter	36 inches
Saw blade motor (30 HP HF-motor)	400 Hz High Frequency Motor
Max continuous output power	30 HP with Pentpak 427
Spindle speed under load	600 - 1000 rpm @ 300-500 Hz *
Saw head weight	54 lbs
Weight (30 HP HF-motor)	40 lbs

*continuously variable from 70 - 100% set potentiometer to control speed

FEATURES AND BENEFITS

- Powerful - cuts up to 28 inches deep in concrete & rebar
- Precise because of rigid aluminum construction
- Portable with each component less than 60 lbs



3P8 HF Wire Saw

The Pentrunder 3P8 wire saw offers extraordinary performance and virtually unlimited sawing depths. The electric automatic feed not only makes the start of the wire simple, but it extends the lifetime of the wire. With a quick and easy setup, thanks to the modular, low weight design, this saw is suitable for both small and large jobs.



FEATURES AND BENEFITS

- Easily control wire tension and slack with tensioning wheel and automatic wire feed.
- Start cuts quickly with high torque, slip resistant system.

TECHNICAL SPECIFICATIONS

Drive motor power	400 Hz High Frequency Motor
Max continuous output power	18 kW (24hp)
Storage in rollers	21 feet
Storage capacity	Up to 66 ft max
1 foot travel of the carriage	30 HP with Pentpak 427
Storage pulleys diameter	8 inches O.D.



ICS Diamond Wire

Continuing the tradition of providing products with the highest level of quality and performance available, ICS is proud to offer the next generation of diamond wire, specifically designed for the applications of cutting concrete, concrete with reinforcement and steel. ICS diamond wire is manufactured in a state-of-the-art facility with precision specifications to deliver the best in service, economy and performance.

Brazed Wire

Brazed wire cuts the most demanding materials and ICS optimizes performance for long life or fast cutting speed as the objective. From pure steel to reinforced concrete, brazed wire is the diamond wire for users on time critical or critically hard applications. Use ICS brazed wire to cut more material daily or cut through the toughest jobs.



Electroplated Wire

The ICS Electroplated diamond wire offering provides several options for economically cutting a wide range of materials from reinforced concrete to pure steel. The proprietary design efficiently uses diamonds that are tuned for each unique application, allowing you to optimize your wire sawing operations.



Sintered Wire

ICS Sintered Super Wire provides a proven and economical way to cut fast in concrete and concrete with light steel. Designed to provide smooth operation and extremely efficient use of the diamonds, ICS Super wire saves you time and money and gets you on to the next job quickly.



SPEC	Wire Type	Application	Attribute	LENGTH (FEET)			BPM	Bead Diameter
				50	100	328		
S14	Sintered	Concrete Structures (S14)	Some Reinforcement	571315	573146		40	11.0
S6	Sintered	Concrete Structures (S6)	Some Reinforcement: Longer Life		576299		40	10.5
E1	Electroplated	Concrete Structures (E1)	Reinforced	571316	573147		40	10.2
B3	Brazed	Concrete Structures (B3)	Reinforced: Faster Cutting	575664	575153	579873	40	10.0
E2	Electroplated	Pure Steel (E2)	Fast Cutting	571317	573148		40	10.8
E4	Electroplated	Pure Steel (E4)	Longer Life	571318	573159		48	10.8
B10	Brazed	Pure Steel (B10)	Longer Life		575155	579874	44	10.2
B17	Brazed	Pure Steel (B17)	Longest Life		575154		53	10.2
E5	Electroplated	Pure Steel - Rescue Wire (E5)	Fast Cutting	571319	573160		40	8.8
E13	Electroplated	Pure Steel - Rescue Wire (E13)	Longer Life		576288		48	8.8
B13	Brazed	Pure Steel - Rescue Wire (B13)	Fast Cutting and Long Life		576287		48	8.8

NEW



CW630 HF

FEATURES AND BENEFITS

- Cut from 10-25 in / 26-63 cm deep with ICS® ProFORCE™ Diamond Chains
- Compatible with PowerGrit® chain to cut ductile iron pipe
- Powerful 12 hp (9kW)
- Machined Billet Aluminum Saw Body
- Easy to use indoors without emissions or hydraulic hoses

CW630 HF Chain Saw

Built to complement Pentrunder wall saws, the CW630 is the most powerful electric chainsaw on the market today with up to 12 hp (9kW) of output power thanks to the digital 400V Pentpak power pack. It is fully compatible with hydraulic 890F4 bars and chains, and cuts up to 25 inches deep. With no emissions or heavy hydraulic hoses, the CW630 is ideal for indoor and obstructed spaces.

TECHNICAL SPECIFICATIONS

Cutting Depth	10-25 in / 26-63 cm
Bar Length	10 in (25 cm) / 15 in (38 cm) / 20 in (50 cm) / 25 in (63 cm)
Output Power	12 hp (9kW)
Motor Speed	6500 rpm
Powerhead Dimensions	Length 26 in (66 cm) / Height 10 in (25 cm) / Width 9.5 in (24 cm)
Noise Level (Sound Pressure Level)	94 dB @ 1 m (3 ft)
Noise Level (Sound Power Level)	103 dB @ 1 m (3 ft)
Vibration Level	2.4 m/sec ² (front handle) / 4.5 m/sec ² (rear handle)
Water Supply	Minimum 20 psi (1.5 bar)
Weight	31 lbs / 14 kg (without bar and chain)



Pentrunder Accessories

Track System



TRACK

ICS Part Number	Description	Pentrunder Item Number
567610	33" TRACK (0.85 M) DOUBLE RACK CPL	49031801
567631	45" TRACK (1.15 M) DOUBLE RACK CPL	49031901
567479	67" TRACK (1.7 M) DOUBLE RACK CPL	49032001
567481	79" TRACK (2.0 M) DOUBLE RACK CPL	49032101
567463	90.5" TRACK (2.3 M) DOUBLE RACK CPL	49032201
567430	11.3' TRACK (3.45 M) DOUBLE RACK CPL	49032301
567814	TRACK FOOT, SYMMETRIC CPL	43101401
567970	ANGLE-ADJUSTABLE TRACK FOOT	43100901
568030	JOINT BLOCK FOR TRACKS CPL.	43280101
568569	TRACK STOP, TP3 CPL.	55070201

Blade Guards & Flush Guards

BLADE GUARDS

ICS Part Number	Description	Pentrunder Item Number
567580	32" BLADE GUARD FULL (800MM+)	11080701
567561	40" BLADE GUARD FULL (1000MM+)	11080801
567515	42" BLADE GUARD FULL (1100MM)	11081601
567524	48" BLADE GUARD FULL (1200MM+)	11080901
567480	54" BLADE GUARD FULL (1400MM+)	11081701
567485	63" BLADE GUARD FULL (1600MM)	11081001
567445	79" BLADE GUARD FULL(2000MM)	11081101
567735	Blade Flange, 1"	42880501
567753	Blade Flange 1 3/8	42880601

FLUSH GUARDS

ICS Part Number	Description	Pentrunder Item Number
567768	32" BLADE GUARD FLUSH (800MM+)	11090601
567648	48" BLADE GUARD FLUSH (1200MM+)	11090801
567756	40" BLADE GUARD FLUSH (1000MM+)	11090701
567587	63" BLADE GUARD FLUSH (1600MM+)	11090901
567882	Flush Flange, 1"	42040801
567914	Flush Flange, 1.375"	42040401

Outperform your competition

This is not your first rodeo. Every day, along with the challenge of cutting through concrete, masonry, stone or utility pipe, you're managing your crew and your equipment to get the maximum return from every dollar.

ICS understands that time is money and that is why ICS and Pentrunder tools are designed with your productivity in mind. Concrete cutting chainsaws that make it easier to tackle hard to reach spots. Diamond Chains with technology built in to prevent stretch and keep you in the cut instead of making adjustments. Wall saws constructed of machined billet aluminum for ultimate accuracy and durability. High frequency power for amazing productivity. ICS PowerGrit®, the utility pipe cutting chain, grinds through iron pipe from one side even while wet or submerged when a belt driven cut off saw slips. Less effort, more productivity.

When you have high quality, powerful, reliable tools, you minimize the effort of your operators, complete jobs more quickly and move on to the next job. The result? Productivity. Operational efficiencies, happy employees and ultimately, more profit for your business.



Frequently Asked Questions

WHEN DO I NEED TO REPLACE A CHAIN?

When the diamond segment has worn down to the welded pad on the chain chassis. Typically a chain will cut 40 – 80 linear feet in 6 inch concrete. On ICS hydraulic saw, this range is most often doubled.



Worn ProFORCE chain



Worn PowerGRIT chain

WHAT IS THE PROPER CHAIN TENSION?

All chains have a tendency to stretch when used. Diamond chains stretch more than wood cutting chains because of the abrasive materials they cut. If the chain is too tight, a lot of the saw's power goes into turning the chain rather than the cut. In extreme over-tightened cases, the saw may not be able to turn the chain at all. In addition, damage can occur to the bar nose and premature stretch may occur.

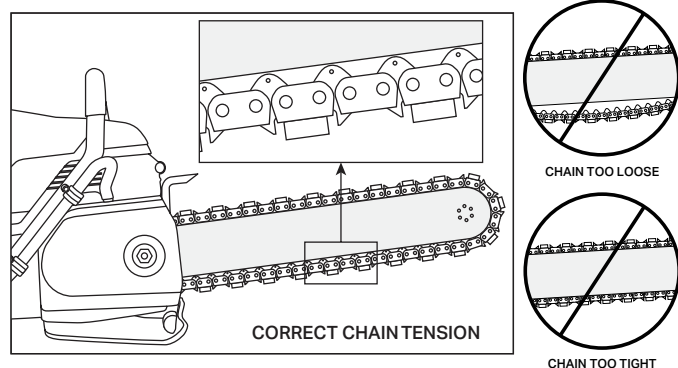

If the chain is too loose, it could come off the bar, or it will allow the drive sprocket to spin without turning the chain, which can chew up drive links. When a chain stretches to a point where the drive links are hanging approximately 1/2 in. (12 mm) to 3/4 in. (18 mm) below the bar, it is time to tension the chain.

See ICS training videos for saw setup

REGARDING CUTTING PIPES THAT ARE FULL OF WATER... CAN I CUT INTO THE PIPE AND RELY ON THE WATER INSIDE TO COOL THE CHAINS (DIAMOND AND POWERGRIT)?

The cooling and lubrication for the chains needs to be delivered thru the saw/guidebar and therefore you must have a minimum of 20 psi/1.5 gpm going through the saw.

CAN I POUR WATER ON THE CHAIN IF I DO NOT HAVE A WATER SOURCE DELIVERABLE THROUGH A HOSE?

The guidebar is designed with water channels that distribute water to the chain to lubricate and cool and also flush the chain of debris. Pouring water on the chain is not only dangerous, it will drastically increase chain stretch and reduce chain and bar life.

YOU DID NOT SPECIFY THE AMOUNT OF WATER NEEDED TO CUT CONCRETE, BRICK, BLOCK OR EVEN DUCTILE IRON PIPE. IS THE WATER REQUIREMENT DIFFERENT FOR THESE?

The water requirement for using the ICS Diamond Chain or the ICS Powergrit Chain to cut any of the above is the same however if you can use more water, especially when cutting abrasive things like brick and block, more water helps to add to longer chain and guidebar life because it is flushing the abrasive materials away.

WHAT IF IT IS FREEZING OR BELOW FREEZING AND I CANNOT GET WATER TO MY SAW BECAUSE THE HOSE OR SAW IS FROZEN AND PLUGGED UP...CAN I MAKE MY CUT?

Water as previously stated is crucial to the performance of these chains. There are several different anti-freeze products you can use in this situation. Contact your regulatory agency for specific details.

WHEN DO I NEED TO REPLACE MY DRIVE SPROCKET?

Drive sprockets need to be replaced when the groove has worn 50% of the way through the top of the sprocket tooth. A rule of thumb for ICS gas saws is every 2-4 chains and for ICS hydraulic saws, every 7-9 chains (depending on chain chassis).

HYDRAULIC



NEW → REPLACE

GAS



NEW → REPLACE

CAN A DIAMOND CHAIN CUT REBAR?

Yes, number 4 or 5 (12 or 16 mm) bar is not a problem. Anything over number 8 (25mm) is difficult. Large amounts of rebar will reduce chain life. Caution: rebar must be surrounded by concrete or aggregate material.

WILL POWERGRIT CUT STEEL?

PowerGrit utility chain is designed to cut ductile iron pipe, cast iron pipe, HDPE and PVC.

WHAT IS THE MIXTURE RATIO OF FUEL TO OIL

Consult your operator manual for the proper fuel to oil mix recommendation.

WHAT STEPS SHOULD I TAKE DAILY TO MAINTAIN MY SAW?

After each use, rinse the saw, bar and chain with water. Inspect all fasteners, sprocket, starter rope and air filter for wear. Oil the guidebar, diamond chain and bar nose sprocket and grease the chain tensioner.

For more information and to view instructional videos, please visit: icsdiamondtools.com.

Part Numbers

695GC GAS SAWS AND CONSUMABLES

PART NUMBER	DESCRIPTION
581192	ICS 695XL GC Powerhead
576150	ICS 695XL-12 GC Gas Saw Package, with 12 in Guidebar & TwinMAX Chain
575863	ICS 695XL-14 GC Gas Saw Package, with 14 in Guidebar & TwinMAX Chain
575865	ICS 695XL-16 GC Gas Saw Package, with 16 in Guidebar & TwinMAX Chain
71400	ICS TwinMAX-29 chain 12 in
71486	ICS TwinMAX-32 chain 14 in
71607	ICS TwinMAX-35 chain 16 in
71704	ICS TwinMAX-29 Plus chain 12 in
71705	ICS TwinMAX-32 Plus chain 14 in
71706	ICS TwinMAX-35 Plus chain 16 in
71554	ICS TwinMAX-29 Abrasive chain 12 in
71610	ICS TwinMAX-32 Abrasive chain 14 in
71611	ICS TwinMAX-35 Abrasive chain 16 in
553207	ICS 695GC Guidebar 12 in
73600	ICS 695GC Guidebar 14 in
71600	ICS 695GC Guidebar 16 in
70949	ICS 695GC Drive Sprocket

695F4 GAS SAWS AND CONSUMABLES

PART NUMBER	DESCRIPTION
575826	ICS 695XL F4 Powerhead
576151	ICS 695XL-12 F4 Gas Saw Package, with 12 in FORCE4 Guidebar & ProFORCE Chain
575872	ICS 695XL-16 F4 Gas Saw Package with 16 in FORCE4 Guidebar & ProFORCE Chain
575827	ICS 695XL-16 PG Gas Saw Package with 16 in FORCE4 Guidebar & PowerGrit Chain
531743	ICS ProFORCE-25 chain 10/12 in
525342	ICS ProFORCE-29 chain 15/16 in
531745	ICS ProFORCE-25 Premium L chain 10/12 in
525343	ICS ProFORCE-29 Premium L chain 15/16 in
531739	ICS ProFORCE-25 Premium S chain 10/12 in
531735	ICS ProFORCE-29 Premium S chain 15/16 in
531747	ICS ProFORCE-25 Abrasive chain 10/12 in
525344	ICS ProFORCE-29 Abrasive chain 15/16 in
537764	ICS PowerGrit Chain 16 in
553208	ICS 695F4 Guidebar 12 in
524490	ICS 695F4 Guidebar 16 in
525496	ICS 695F4 Drive Sprocket

680GC GAS SAWS AND CONSUMABLES

PART NUMBER	DESCRIPTION
576155	ICS 680ES Powerhead
576154	ICS 680ES-12 GC Gas Saw Package, with 12 in Guidebar & TwinMax Chain
576153	ICS 680ES-14 GC Gas Saw Package, with 14 in Guidebar & TwinMax Chain
580423	ICS 680ES-10 PG Gas Saw Package, with 10 in Guidebar & PowerGrit Chain
580424	ICS PowerGrit-24 chain 10 in
579158	ICS 680 PowerGrit Guidebar 10 in
525496	ICS 680ES PowerGrit Drive Sprocket
71400	ICS TwinMAX-29 chain 12 in
71486	ICS TwinMAX-32 chain 14 in
71704	ICS TwinMAX-29 Plus chain 12 in
71705	ICS TwinMAX-32 Plus chain 14 in
71554	ICS TwinMAX-29 Abrasive chain 12 in
71610	ICS TwinMAX-32 Abrasive chain 14 in
71395	ICS 680GC Guidebar 12 in
513122	ICS 680GC Guidebar 14 in
70949	ICS 680GC Drive Sprocket

814PRO HYDRAULIC SAWS AND CONSUMABLES

PART NUMBER	DESCRIPTION
75256	ICS 814PRO Powerhead 8 gpm
71675	ICS 814PRO Saw Package 8 gpm with 13 inch Guidebar & TwinPRO Diamond Chain
74719	ICS TwinPRO-25 chain 13 inch
74042	ICS t Guidebar 13 inch
71385	ICS 814PRO Drive Sprocket

Part Numbers

890F4 HYDRAULIC SAWS AND CONSUMABLES

PART NUMBER	DESCRIPTION
566110	ICS 890F4 Powerhead 8 gpm, 1 ft hose whips
566355	ICS 890F4 Powerhead 8 gpm, 8 ft hose whips
566112	ICS 890F4 Powerhead 12 gpm, 1 ft hose whips
566116	ICS 890F4 Powerhead 12 gpm, 8 ft hose whips
566113	ICS 890F4-FLUSH Powerhead 8 gpm, 1 ft hose whips
566351	ICS 890F4-FLUSH Powerhead 8 gpm, 8 ft hose whips
566114	ICS 890F4-FLUSH Powerhead 12 gpm, 1 ft hose whips
566117	ICS 890F4-FLUSH Powerhead 12 gpm, 8 ft hose whips
566127	ICS 890F4-15 Saw Package 8 gpm with 15 inch Guidebar, ProFORCE chain, 1 ft hose whips, case
566717	ICS 890F4-15 Saw Package 8 gpm with 15 inch Guidebar, ProFORCE chain, 8 ft hose whips, case
566123	ICS 890PG-15 Saw Package 8 gpm, 15 inch Guidebar, PowerGrit chain, 1 ft hose whips, case
566710	ICS 890PG-15 Saw Package 8 gpm, 15 inch Guidebar, PowerGrit chain, 8 ft hose whips, case
566125	ICS 890PG-15 Saw Package 12 gpm, 15 inch Guidebar, PowerGrit chain, 1 ft hose whips, case
566712	ICS 890PG-15 Saw Package 12 gpm, 15 inch Guidebar, PowerGrit chain, 8 ft hose whips, case
566124	ICS 890PG-20 Saw Package 8 gpm, 20 inch Guidebar, PowerGrit chain, 1 ft hose whips, case
566711	ICS 890PG-20 Saw Package 8 gpm, 20 inch Guidebar, PowerGrit chain, 8 ft hose whips, case
566126	ICS 890PG-20 Saw Package 12 gpm, 20 inch Guidebar, PowerGrit chain, 1 ft hose whips, case
566716	ICS 890PG-20 Saw Package 12 gpm, 20 inch Guidebar, PowerGrit chain, 8 ft hose whips, case
529829	ICS 890F4 Guidebar 10 inch
523080	ICS 890F4 Guidebar 15 inch
529767	ICS 890F4 Guidebar 20 inch
525320	ICS 890F4 Guidebar 25 inch
531743	ICS ProFORCE-25 chain 10/12 inch
525342	ICS ProFORCE-29 chain 15/16 inch
531749	ICS ProFORCE-34 chain 20 inch
525345	ICS ProFORCE-40 chain 25 inch
531745	ICS ProFORCE-25 Premium L chain 10/12 inch
525343	ICS ProFORCE-29 Premium L chain 15/16 inch
531751	ICS ProFORCE-34 Premium L chain 20 inch
525346	ICS ProFORCE-40 Premium L chain 25 inch
531739	ICS ProFORCE-25 Premium S chain 10/12 inch
531735	ICS ProFORCE-29 Premium S chain 15/16 inch
531741	ICS ProFORCE-34 Premium S chain 20 inch
531737	ICS ProFORCE-40 Premium S chain 25 inch
531747	ICS ProFORCE-25 Abrasive chain 10/12 inch
525344	ICS ProFORCE-29 Abrasive chain 15/16 inch
531753	ICS ProFORCE-34 Abrasive chain 20 inch

525347	ICS ProFORCE-40 Abrasive chain 25 inch
537764	ICS PowerGrit Chain 15 inch
537765	ICS PowerGrit Chain 20 inch
545017	ICS PowerGrit Chain 25 inch
565065	ICS 890F4 Drive Sprocket
565066	ICS 890F4-FLUSH Drive Sprocket

701-A PNEUMATIC SAW AND CONSUMABLES

PART NUMBER	DESCRIPTION
573511	ICS 701-A Powerhead
574173	ICS 701-A Saw Package with 15" Guidebar and ProFORCE Chain
574171	ICS 701-A Saw Package with 15" Guidebar and PowerGrit Chain
574172	ICS 701-A Saw Package with 20" Guidebar and PowerGrit Chain
523080	ICS 890F4 Guidebar 15 inch
529767	ICS 890F4 Guidebar 20 inch
525320	ICS 890F4 Guidebar 25 inch
525342	ICS ProFORCE-29 chain 15/16 inch
531749	ICS ProFORCE-34 chain 20 inch
525345	ICS ProFORCE-40 chain 25 inch
525343	ICS ProFORCE-29 Premium L chain 15/16 inch
531751	ICS ProFORCE-34 Premium L chain 20 inch
525346	ICS ProFORCE-40 Premium L chain 25 inch
531735	ICS ProFORCE-29 Premium S chain 15/16 inch
531741	ICS ProFORCE-34 Premium S chain 20 inch
531737	ICS ProFORCE-40 Premium S chain 25 inch
525344	ICS ProFORCE-29 Abrasive chain 15/16 inch
531753	ICS ProFORCE-34 Abrasive chain 20 inch
525347	ICS ProFORCE-40 Abrasive chain 25 inch
537764	ICS PowerGrit Chain 15 inch
537765	ICS PowerGrit Chain 20 inch
545017	ICS PowerGrit Chain 25 inch



Diamond Tools and Equipment

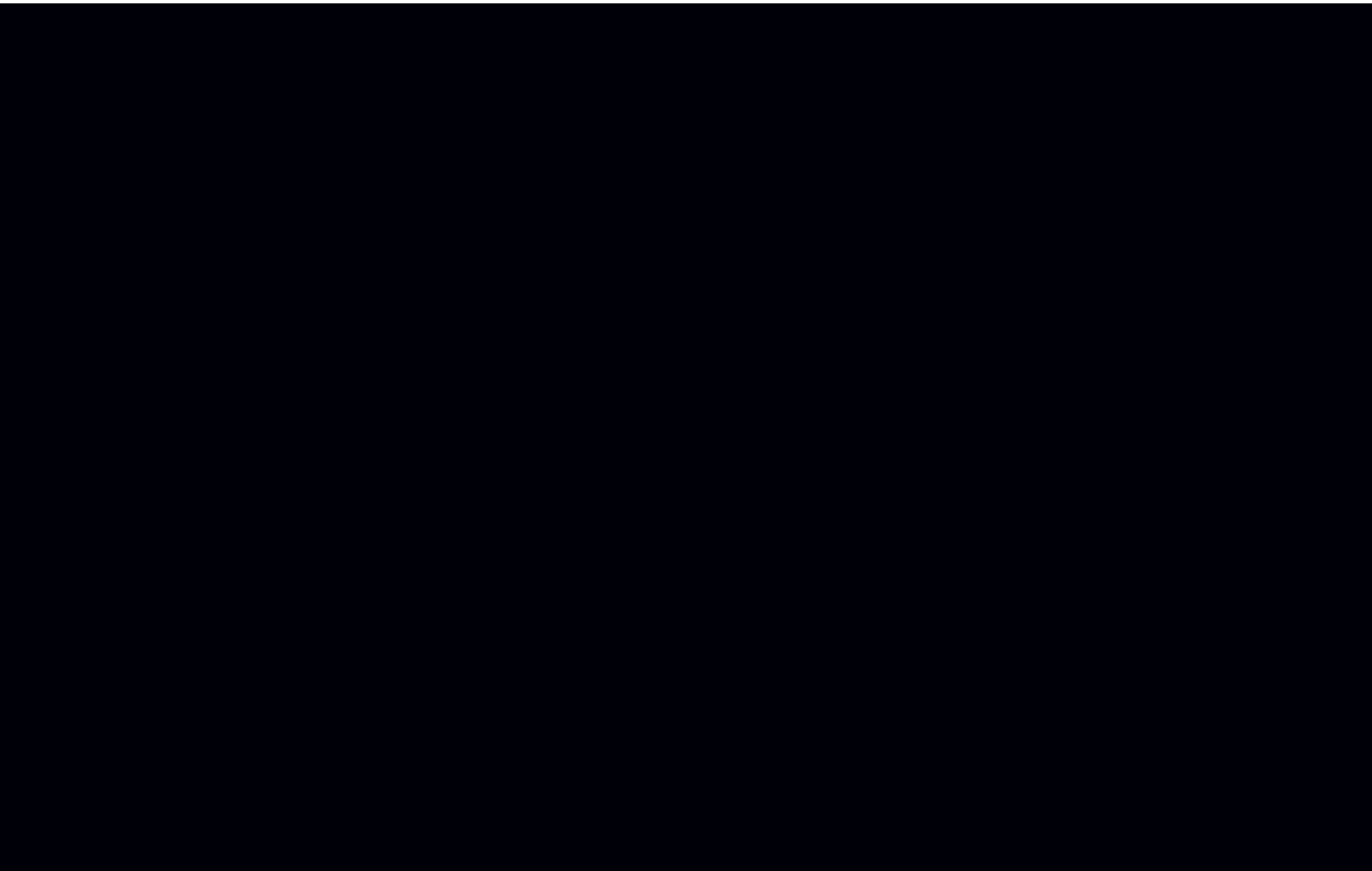

ICS | Blount, Inc
4909 SE International Way • Portland OR 97222 • USA
T 800.321.1240 • F 503.653.4393