

BURR KING®

MODEL 150 - 10 Quart Bowl
MODEL 200 - 20 Quart Bowl

1220 Tamara Lane
 Warsaw, MO 65355

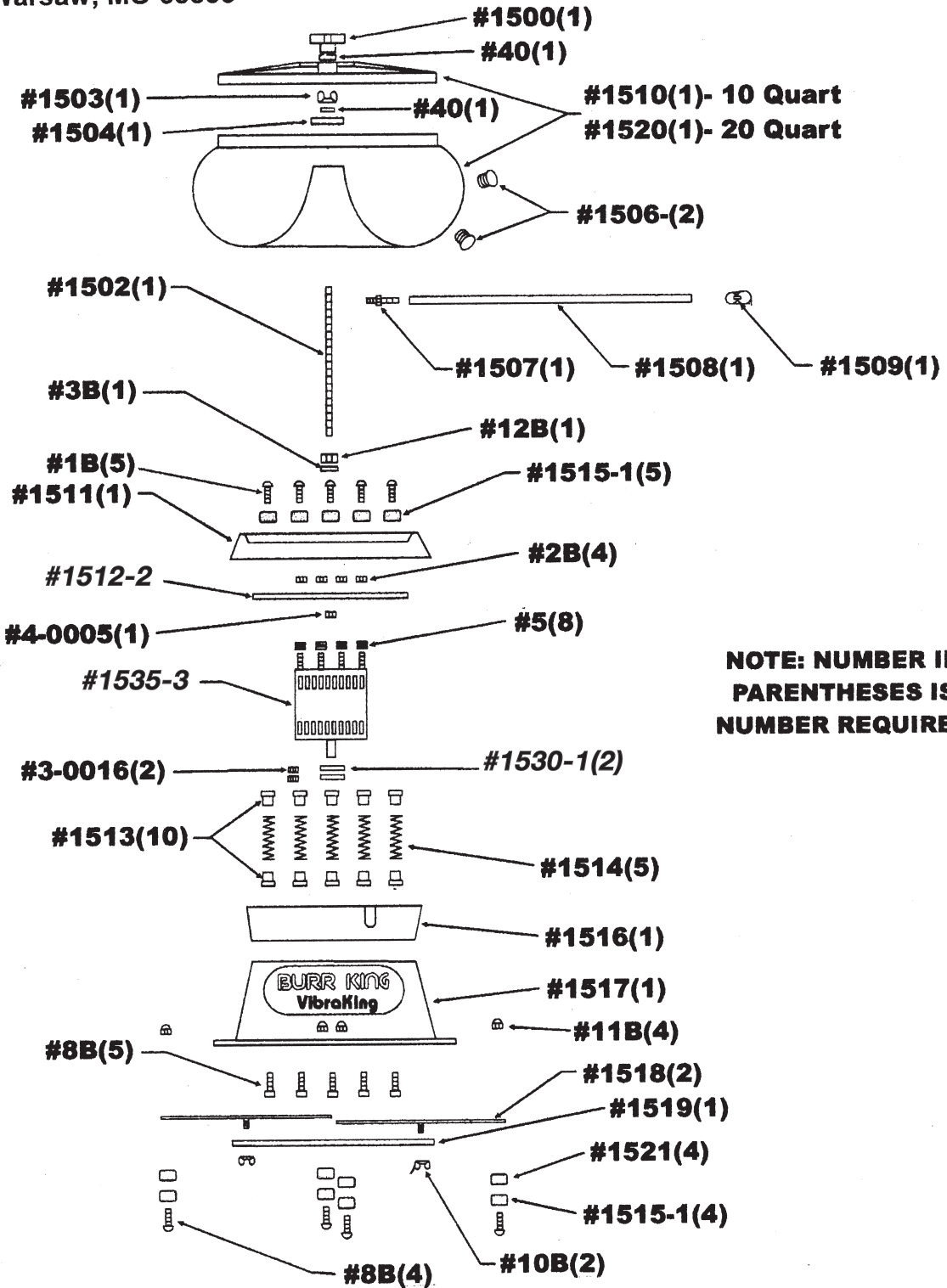

NOTE: NUMBER IN PARENTHESES IS NUMBER REQUIRED

(SEE REVERSE SIDE FOR PART DESCRIPTION)



BURR KING MFG. CO., INC.

1220 TAMARA LANE

WARSAW MO 65355

WWW.BURRKING.COM

(660) 438-8998 ♦ (800) 621-2748

FAX (660) 438-8991

Master Parts Listing for Models 150 and 200 VibraKing Bowls Stock Codes – 15000-1 & 20000-1

<u>PART NUMBER</u>	<u>DESCRIPTION</u>	<u>QTY.</u>
• 1B	¼-20 X 1 ½ PAN HEAD PHILLIPS	5
• 2B	10-32 NYLOCK NUT	4
• 3B	3/8 EXTERNAL LOCK WASHER	1
• 8B	¼-20 X 1 PAN HEAD PHILLIPS	9
• 10B	¼-20 WING NUT	2
• 11B	¼-20 ACORN NUT	4
• 12B	3/8-16 HEX NUT (TOP OF ALL TREAD)	1
• 4-0005	3/8-16 JAM NYLOCK (BOTTOM OF ALL THREAD)	
• 3-0016	10-24 X ¼ BRASS TIP SET SCREW	
• 5-0019	3/32 ALLEN WRENCH KEY	
• 40	3/8 SAE WASHER	2
• 1500	KNOB	1
• 1502	3/8 ALL THREAD	1
• 1503	3/8-16 WING NUT	1
• 1504	WASHER	1
• 1506	PLASTIC PLUG	2
• 1507	PLASTIC ADAPTER	1
• 1508	PLASTIC HOSE	1
• 1509	HOSE CLAMP	1
• 1510	10 QT. BOWL & LID	1
• 1511	SPRING SKIRT	1
• 1512	MOTOR MOUNT PLATE	1
• 1513	SPRING PERCH	10
• 1514	SPRING	5
• 1515-1	RUBBER GROMMET (80 DURO)	9
• 1516	SPRING COVER	1
• 1517	BASE	1
• 1518	BRACKET	2
• 1519	SAFETY SCREEN	1
• 1520	20 QT. BOWL & LID	1
• 1521	SPACER	4
• 1530-1	WEIGHTS (NEW STYLE)	2
• 1535-3	MOTOR (NEW STYLE)	1
•	CONTACT FACTORY FOR MOTOR OPTIONS	10/2007