



Diamond Tools and Equipment



2015 PRODUCT CATALOG

icsdiamondtools.com



FORCE4® INNOVATIVE TECHNOLOGY

Our goal was simple: Make the strongest, longest-lasting diamond chain ever. After four years in development, including input from experts like you, the FORCE4 system was born.

As concrete cutting pros, you need dependable tools that work every day, all day, and under the toughest conditions. The most durable system in our line, FORCE4 doesn't sacrifice any of the precision and versatility you've come to expect from ICS. Our patented chain design creates the optimal combination of weight and strength, and gives the chain smooth cutting performance and maximum life. Available for hydraulic, pneumatic and gas-powered saws, FORCE4 is a true revolution in diamond chain technology.



Diamond Tools and Equipment

T 800.321.1240

3

TABLE OF CONTENTS



CONCRETE CUTTING SOLUTIONS

ICS Gas Power Saws	6 - 7
ICS Hydraulic Power Saws.....	8 - 9
ICS Pneumatic Power Saw	9

ICS SUCCESS STORIES

Notre Dame Cathedral.....	10
PowerGrit.....	11

PIPE CUTTING SOLUTIONS

Applications & Information	12 - 13
ICS PowerGrit Gas Saw & Chain.....	14
ICS PowerGrit Hydraulic Saw & Chain.....	15

ICS DIAMOND TOOLS & ACCESSORIES

ICS Diamond Chains.....	16 - 17
Accessories.....	18 - 19
Diamond Blades	20
Diamond Core Bits & Accessories.....	21
Diamond Wire & Accessories	22 - 23
Pentruder Information.....	24
Pentruder Wall Saws.....	25 - 26
Pentruder Wire Saw.....	27

FAQ'S, & PART NUMBERS

FAQ's & Information	28 - 29
Part Numbers.....	30 - 31

ICS | Blount, Inc • 4909 SE International Way • Portland OR 97222 • USA • T 800.321.1240 • F 503.653.4393

Copyright 2015 ICS|Blount Inc. Pricing and specifications subject to change without notice. All rights reserved. ICS, EuroMAX, FORCE4, PowerGRIT, WallWalker, SpeedHook and SealPro are registered trademarks of ICS. The best way to cut concrete, DCT, TSS, TwinPRO, and ProFORCE are trademarks of ICS. 0115

ICS HISTORY



PRECISION. POWER. PERFORMANCE. SAFETY.

ICS® is on a mission to help you get the job done right, and faster and easier than you ever thought possible. For more than 20 years, our innovations in diamond tools and equipment have revolutionized the cutting, drilling, demolition, and finishing of concrete and other hard materials—changing the way you work.

Our patented ICS diamond chains, blades, wires, and core bits, and Pentruder® saws and core drills, satisfy a full-range of infrastructure and construction applications. Your job demands power and precision, and we make tough, professional-quality tools that can do it right. Deep plunge cuts, tight radiuses, clean square corners, concrete pipe taps; you're only limited by your sense of what's possible. And with end-to-end service from committed experts, you get the peace of mind to focus on what you do best.

Headquartered in Portland, Oregon, as a division of Blount International, ICS also has a sales and distribution office in Belgium and a worldwide sales and service network covering more than 70 countries. ICS concrete chain saws, diamond chains, and related products are sold and supported by a network of ICS Authorized Dealers and backed by a comprehensive network of factory-trained personnel and service centers.



Diamond Tools and Equipment

T 800.321.1240

5

ICS GAS POWERED SAWS

695F4



FEATURES AND BENEFITS

- Best performance bar and chain
- Operates ProFORCE™ and PowerGrit® Chains
- Longer chain life with Force4™ Technology
- Cuts many types of materials

PART NUMBER	DESCRIPTION
545089	ICS 695F4 Powerhead
553463	ICS 695F4-12 Gas Saw Package, with 12 inch FORCE4 Guidebar & ProFORCE Chain
546804	ICS 695F4-16 Gas Saw Package with 16 inch FORCE4 Guidebar & ProFORCE Chain

695GC & 695F4

Over 20 years of ICS® product innovation and experience culminating in the latest addition to our gas saw family. Everything that makes chain saws the preferable method in cutting concrete, stone, and masonry wrapped in a hungry, power filled package called the 695. All the great features from past ICS chain saws plus a few new innovations to make your day go a little easier. Deep, straight cuts and square corners with ease of use and dependable performance to match.

TECHNICAL SPECIFICATIONS

Weight	21 lbs/9.6 kg (without bar and chain)
Bar Length	Up to 16" (40 cm)
Engine Speed	11500 +/- 500 rpm, 2500-2800 rpm idle
Powerhead Dimensions	19 inches (48 cm) Length 14 inches (36 cm) Height 12 inches (30 cm) Width
Horsepower	6.4 @ 9000 rpm
Engine Type	2-stroke, single cylinder, air cooled
Displacement	5.7 cu. inch (94 cc)
Fuel Mix Ratio	50:1 (2%) fuel-to-oil)
Water Supply	Minimum of 20 psi (1.5 bar)

695GC



FEATURES AND BENEFITS

- Decreases fatigue with vibration stability
- Best value
- Excellent power to weight ratio
- Designed for frequent heavy use

PART NUMBER	DESCRIPTION
544106	ICS 695GC Powerhead
553464	ICS 695GC-12 Gas Saw Package, with 12 inch Guidebar & TwinMAX Chain
544107	ICS 695GC-14 Gas Saw Package, with 14 inch Guidebar & TwinMAX Chain
544108	ICS 695GC-16 Gas Saw Package, with 16 inch Guidebar & TwinMAX Chain



SOLUTIONS FOR CONCRETE, MASONRY, STONE



FEATURES AND BENEFITS

- Best price
- Lightweight and portable
- Expert tool at entry level price
- Decompression valve for easy starting

PART NUMBER	DESCRIPTION
545090	ICS 680GC Powerhead
545058	ICS 680GC-12 Gas Saw Package, with 12 inch Guidebar & TwinMax Chain
545099	ICS 680GC-14 Gas Saw Package, with 14 inch Guidebar & TwinMax Chain

TECHNICAL SPECIFICATIONS

Weight	21 lbs (9.5 kg) without bar and chain
Bar Length	Up to 14 in (35 cm)
Engine Speed	11500 +/- 500 rpm, 2800-3200 rpm idle
Powerhead Dimensions	18 inches (46 cm) Length 11.5 inches (29 cm) Height 10 inches (25 cm) Width
Horsepower	5 hp (3.7 kW) @ 9500 rpm
Engine Type	2-stroke, single cylinder, air cooled
Displacement	4.7 cu. inch (76.5 cc)
Fuel Mix Ratio	25:1 (4%) fuel-to-oil
Water Supply	Minimum 20 psi (1.5 bar)

680GC

Built to meet the operational and flexibility demands of the general construction audience, the 680GC stands alone in terms of reliability and value. Packed with innovations and loaded with dependability, the 680GC is the perfect saw for the less frequent user. The powerhead houses carburetion and ignition systems that work together to ensure easy starting, cooler operation, and dependable performance. Improved airflow design keeps the engine much cooler, extending its life. Available with 12" (30 cm) and 14" (35 cm) guidebars and the entire line of TwinMAX™ diamond chain.



ICS HYDRAULIC POWERED SAWS

**WORKS WITH POWERGRIT®
UTILITY SAW CHAIN - SEE PAGE 15**



890F4 FEATURES AND BENEFITS

- Most professional
- Optimum chain performance
- Easy starting
- Submersible

PART NUMBER	DESCRIPTION
566110	ICS 890F4 Powerhead 8 gpm, 1 ft hose whips
566355	ICS 890F4 Powerhead 8 gpm, 8 ft hose whips
566112	ICS 890F4 Powerhead 12 gpm, 1 ft hose whips
566116	ICS 890F4 Powerhead 12 gpm, 8 ft hose whips
566127	ICS 890F4-15 Saw Package 8 gpm with 15 inch Guidebar, ProFORCE chain, 1 ft hose whips, case
566717	ICS 890F4-15 Saw Package 8 gpm with 15 inch Guidebar, ProFORCE chain, 8 ft hose whips, case



890F4-FL FEATURES AND BENEFITS

- Cuts within 3/16" of a wall
- Optimum chain performance
- Most professional
- Easy starting
- Submersible

PART NUMBER	DESCRIPTION
566113	ICS 890F4-FL Powerhead 8 gpm, 1 ft hose whips
566351	ICS 890F4-FL Powerhead 8 gpm, 8 ft hose whips
566114	ICS 890F4-FL Powerhead 12 gpm, 1 ft hose whips
566117	ICS 890F4-FL Powerhead 12 gpm, 8 ft hose whips

890 Series

Over 20 years of ICS® product innovation and The ICS 890 Series hydraulic cutting system offers the superior strength of FORCE4® technology. From the redesigned, more durable rear handle, to the easy to replace drive sprocket, this saw is engineered to stand up to your toughest jobs. In a package that exceeds industry standards this sleek powerhouse is packed with features designed to make it work as hard as you do.

TECHNICAL SPECIFICATIONS

	8 GPM	12 GPM
Weight	27.3 lbs (12.4 kg) with 15-inch (38 cm) bar and chain	
Bar Length	Up to 25 inches (63 cm)	
Motor Speed	6100 rpm	6500 rpm
Powerhead Dimensions	23 inches (58.5 cm) Length 10.5 inches (26.5 cm) Height 9.5 inches (24 cm) Width	
Torque	122 in-lbs (13.8 Nm)	170 in-lbs (19.2 Nm)
Horsepower	11.5 hp (8.5 kW)	17.5 hp (13 kW)
Hydraulic Supply	8 gpm (30 lpm), 2500 psi (172.5 bar)	12 gpm (45 lpm), 2500 psi (172.5 bar)
Noise Level	107 dB @ 3 ft (1 m)	
Water Supply	Minimum 20 psi (1.5 bar)	

* product data shown is rated based on maximum input conditions and efficiency assumptions may vary dependent on power supply.



ICS HYDRAULIC & PNEUMATIC SAWS



FEATURES AND BENEFITS

- Lightweight
- Fits into small spaces
- Same power as the 890 Series saws

PART NUMBER	DESCRIPTION
75256	ICS 814PRO Powerhead 8 gpm
71675	ICS 814PRO Saw Package 8 gpm with 13 inch Guidebar & TwinPRO Diamond Chain

814PRO

It may be small but with as much power as the 890 series, the 814PRO is ready for the big jobs. Lighter than other hydraulic saws with the ability to cut perfectly square openings as small as 3.5 inches (9 cm), the 814PRO is a natural for utility work and other applications where a mix of portability and power are required.

TECHNICAL SPECIFICATIONS

Weight	15 lbs (6.8 kg) with 13-inch (32 cm) bar and chain
Bar Length	13 inches (32 cm)
Motor Speed	8800 rpm
Powerhead Dimensions	14.3 inches (36.3 cm) Length 11.3 inches (28.7 cm) Height 9.2 inches (23.4 cm) Width
Torque	84 in-lbs
Horsepower	11.5 hp (8.5 kW)
Hydraulic Supply	8 gpm (30 lpm), 2500 psi (172.5 bar)
Noise Level	88 dB @ 3 ft (1 m)
Water Supply	Minimum 20 psi (1.5 bar)

* product data shown is rated based on maximum input conditions and efficiency assumptions may vary dependent on power supply.

ICS PNEUMATIC SAW



701-A

Built tough to stand up to everyday use in the harsh environment of concrete cutting. Cut with ease, speed and portability through Reinforced Concrete, Brick, Block, Concrete Pipe, Ductile Iron, Cast Iron, PVC and Natural Stone. The ICS powerful air saw is designed to cut through walls, floors and columns in a single pass.

PART NUMBER	DESCRIPTION
573511	ICS 701-A Powerhead
574173	ICS 701-A Saw Package with 15 inch Guidebar & ProFORCE chain
574171	ICS 701-A Saw Package with 15" Guidebar & PowerGrit Chain
574172	ICS 701-A Saw Package with 20" Guidebar & PowerGrit Chain

FEATURES AND BENEFITS

- No gas or fumes
- Easy to maintain
- High Torque
- Modular design for easy servicing

TECHNICAL SPECIFICATIONS

Weight	33.6 lbs (15.24 kg) with 15-inch (38 cm) bar and chain
Bar Length	Up to 20 inches (58.5 cm)
Powerhead Dimensions	20 inches (58.5 cm) Length 10.5 inches (26.5 cm) Height 12 inches (30.48 cm) Width
Air Motor Power	6.5 Horse Power (5 KW)
Air Supply Requirements (maximum)	90 psi (6 bar) 124 cfm (3.5 m³/min)
Water Supply	Minimum 20 psi (1.5 bar)
Water Flow Requirements	1 gpm (4 lpm) minimum

* product data shown is rated based on maximum input conditions and efficiency assumptions may vary dependent on power supply.

SUCCESS STORIES

AN AMERICAN IN PARIS

Precision renovation

Background

When renovations began on Notre Dame Cathedral in Paris, local contractor Quelin partnered with ATDV, an ICS® distributor, to make sure the construction was as precise and low impact as possible.

The challenge

Even an architectural masterpiece built from massive natural stones is susceptible to a bit of wear and tear. Over the years, a combination of harsh weather, wars, pollution, and high water have taken their toll on the iconic structure. Damaged stones needed to be replaced and sculptures replicated.

The solution

The traditional method for replacing stones involved inserting a dry piece of wood into a section, then wetting it to “explode” the stone. No more. ICS Diamond Chain Technology™ made it possible to use the “drawer” method. The damaged stone is removed in slices, creating a rectangular hole that can be filled with healthy stone and sealed with lime.

After reopening the original quarry and extracting new stones, artisan stone cutters used ICS chain saws to tailor new blocks as closely to the originals as possible. The saws were also used to carve replacement replicas of the original gargoyles and other sculptures.



The result

The Notre Dame project was so successful that other monuments in Paris, including the Pont Neuf (the oldest bridge in Paris), have been or will be renovated in the same fashion, with ICS technology leading the way.

CHANGE IS GOOD

Safety solutions

Background

The ICS® PowerGrit® Utility Chain Saw is the world's largest water company's saw of choice when cutting pipe in the trench. Beginning in 2012 and again in 2014, several of the world's leading water companies initiated a transition to the ICS PowerGrit Utility Chain Saw for increased operator safety, speed and ease of use.

The challenge

Historically, private water companies and public municipalities cut pipe with general-purpose cut-off saws. But when cutting the lower third of a pipe, this method can produce rotational kickback—a rapid reaction force created if a blade slows or stops suddenly. Because safety is a top priority for these companies, they began looking for ways to solve this problem.

The solution

In 2012 and again in 2014 several companies began a company-wide transition to ICS PowerGrit technology. It was an easy decision.

- Improved safety and control
- No rotational kickback
- Single-side access
- Reduced excavation



The result

Switching to ICS has had an overwhelmingly positive impact. Pipe-cutting operators now have more control, with safer and more comfortable positioning. And with a greater cutting depth, the lower third of a pipe is now more accessible, reducing excavation and allowing for faster main repairs. That's good news for water companies. And even better for their customers, who've seen a reduction in service downtime during repairs.

THE ICS POWERGRIT ADVANTAGE

PowerGrit – Safer. Faster. Easier.

ICS Utility chainsaws have addressed operator safety with its revolutionary grinding technology which eliminates rotational kickback and offers improved operator positioning when cutting pipe. Utilized by public, private water and wastewater departments worldwide, this patented platform, exclusively from ICS, is designed to cut a variety of materials from ductile iron to plastic pipe with far less excavation. The ability to cut up to 24" pipe completely from one side radically reduces the difficulty of the job. Complete your next job safer, faster and easier with ICS Utility chain saws.

FEATURES AND BENEFITS

- No rotational kickback
- Single-point access
- Operator control
- Safer operation
- No flying debris or dust

CUTS APPLICATIONS:

- Ductile Iron Pipe
- Cast Iron Pipe
- PVC Pipe
- HDPE Pipe
- Insituform Pipe Lining
- Asbestos* Cement Pipe



Brazed Diamond Layer



SOLUTIONS FOR UTILITY PIPE



ICS PowerGrit Method Versus Conventional Method

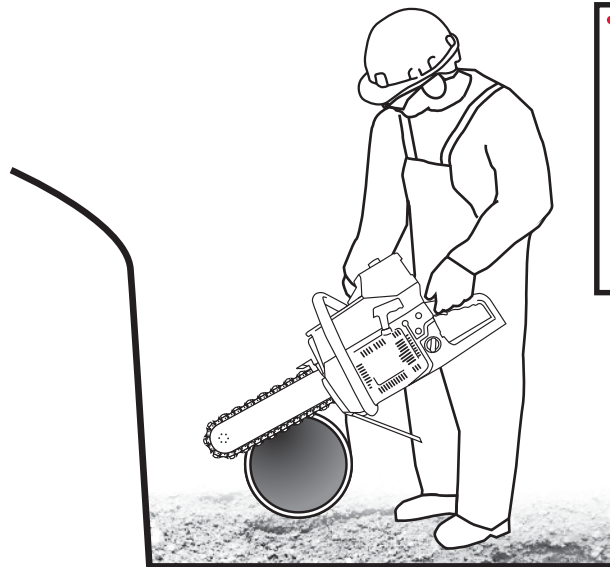

ICS PowerGrit® Method

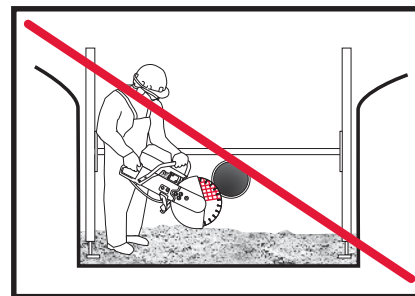

Conventional Method

ICS POWERGRIT METHOD

- Cutting depth from 15 - 25 inches (38 - 63 cm)
- No rotational kickback
- Gyroscopic motion eliminated
- Chain stops quickly after throttle is released
- Direct drive sprocket eliminates slippage
- Cutting depth allows for single side access
- Reduced excavation below the pipe, may eliminate the need for shoring

CONVENTIONAL METHOD

- Cutting depth of only 4-5 inches (10 - 12 cm)
- Operator exposed to potential rotational kickback
- Gyroscopic motion reduces saw control
- Blade continues turning after throttle is released
- Excess excavation needed to cut below the pipe
- Access to both sides of pipe is required
- Guard positioning compromises operator safety

Not all cities, municipalities, townships, and governments follow the same laws. Be sure to adhere to local guidelines and regulations when operating our products.

* Asbestos is a hazardous material, known to cause serious respiratory diseases. Cutting into asbestos can release asbestos fibers into the air. Always research and follow the correct safety procedures, including applicable national and state or provisional occupational health and safety regulations, and protect yourself and those around you from asbestos-related disease. Always arrange for the material to be removed safely by a qualified person. ICS is not responsible for exposure to asbestos caused by use of this product.

THE ICS POWERGRIT ADVANTAGE



**ALSO CUTS CONCRETE, STONE,
BRICK & MASONRY - SEE PAGE 6**

FEATURES AND BENEFITS

- Longer chain life with Force4™ Technology
- Ultimate versatility and power
- Also operates ProFORCE™ chain

PART NUMBER	DESCRIPTION
545089	ICS 695F4 Powerhead
545018	ICS 695PG-16 Gas Saw Package with 16 inch FORCE4 Guidebar & PowerGrit Chain



695PG

Gas-Powered Utility Chain Saw

Built to provide the best combination of performance and portability for cutting in-ground utility pipe, the 695PG Gas-Powered Utility Chain Saw with PowerGrit® chain will change the way you cut pipe. The 695PG offers an unmatched power to weight ratio, allowing you to cut up to 16" deep from one side into ductile iron, cast iron, PVC, HDPE, and Insituform lining. Also the 695PG is capable of operating the full line of 16" ProFORCE™ concrete cutting chains, meaning you can use the saw on masonry, stone, and even reinforced concrete - perfect for pipe taps, utility vaults, bridge work, and other utility applications.

TECHNICAL SPECIFICATIONS

Weight	21 lbs/9.6 kg (without bar and chain)
Bar Length	Up to 16" (40 cm)
Engine Speed	11500 +/- 500 rpm, 2500-2800 rpm idle
Powerhead Dimensions	19 inches (48 cm) Length 14 inches (36 cm) Height 12 inches (30 cm) Width
Horsepower	6.4 @ 9000 rpm
Engine Type	2-stroke, single cylinder, air cooled
Displacement	5.7 cu. inch (94 cc)
Fuel Mix Ratio	50:1 (2%) fuel-to-oil)
Water Supply	Minimum of 20 psi (1.5 bar)



SOLUTIONS FOR UTILITY PIPE



**ALSO CUTS CONCRETE, STONE,
BRICK & MASONRY - SEE PAGE 8**

FEATURES AND BENEFITS

- Also operates ProFORCE™ diamond chain
- Increased safety
- Better operator control
- Reduced excavation
- Versatility

PART NUMBER	DESCRIPTION
566123	ICS 890PG-15 Saw Package 8 gpm, 15 inch Guidebar, PowerGrit chain, 1 ft hose whips, case
566710	ICS 890PG-15 Saw Package 8 gpm, 15 inch Guidebar, PowerGrit chain, 8 ft hose whips, case
566125	ICS 890PG-15 Saw Package 12 gpm, 15 inch Guidebar, PowerGrit chain, 1 ft hose whips, case
566712	ICS 890PG-15 Saw Package 12 gpm, 15 inch Guidebar, PowerGrit chain, 8 ft hose whips, case
566124	ICS 890PG-20 Saw Package 8 gpm, 20 inch Guidebar, PowerGrit chain, 1 ft hose whips, case
566711	ICS 890PG-20 Saw Package 8 gpm, 20 inch Guidebar, PowerGrit chain, 8 ft hose whips, case
566126	ICS 890PG-20 Saw Package 12 gpm, 20 inch Guidebar, PowerGrit chain, 1 ft hose whips, case
566716	ICS 890PG-20 Saw Package 12 gpm, 20 inch Guidebar, PowerGrit chain, 8 ft hose whips, case

890PG

Hydraulic-Powered Utility Chain Saw

If you're looking for the highest level of performance and cutting capability, look no further. The 890PG Hydraulic-Powered Utility Chain Saw offers cutting depths up to 25" in ductile iron, cast iron, PVC, HDPE, and Insituform lining. The deep cutting ability of the 890PG with PowerGrit® utility chain, allows the operator to make a single cut from one side meaning less excavation is required. The 890PG is also capable of operating the full-line of 890F4 ProFORCE™ concrete cutting chains, meaning you can use the saw on masonry, stone, and even reinforced concrete - perfect for pipe taps, utility vaults, bridge work, and other utility applications.

TECHNICAL SPECIFICATIONS

	8 GPM	12 GPM
Weight	27.3 lbs (12.4 kg) with 15-inch (38 cm) bar and chain	
Bar Length	Up to 25 inches (63 cm)	
Motor Speed	6100 rpm	6500 rpm
Powerhead Dimensions	23 inches (58.5 cm) Length 10.5 inches (26.5 cm) Height 9.5 inches (24 cm) Width	
Torque	122 in-lbs (13.8 Nm)	170 in-lbs (19.2 Nm)
Horsepower	11.5 hp (8.5 kW)	17.5 hp (13 kW)
Hydraulic Supply	8 gpm (30 lpm), 2500 psi (172.5 bar)	12 gpm (45 lpm), 2500 psi (172.5 bar)
Noise Level	107 dB @ 3 ft (1 m)	
Water Supply	Minimum 20 psi (1.5 bar)	

* product data shown is rated based on maximum input conditions and efficiency assumptions may vary dependent on power supply.



ICS DIAMOND CHAIN

Diamond Chain Technology

Diamond chains are not all created equal, so insist on Diamond Chains from ICS®, the people who invented the technology. As the inventors of Diamond Chain Technology™, ICS is committed to continually improving the quality and versatility as well as the perfect blend of power, precision and efficiency: chains specifically designed for different saw types as well as the many different materials you encounter on the job. Choosing the right chain for your needs is essential to getting the best value for your purchase.

FORCE4® SERIES DIAMOND CHAIN

- Strongest, most durable, patented chain design
- Laser welded diamond segments
- Contains SealPRO O-ring technology for longer life
- Designed for heavy, professional use

MAX SERIES DIAMOND CHAIN

- Segments designed for general use
- Laser welded to patented chain chassis
- Contains patented SealPRO® O-ring technology for longer life
- Segment types for general and specialty applications

POWERGRIT UTILITY CHAIN

- Single brazed diamond layer
- Patented cutter design
- Available for gas, hydraulic and pneumatic
- Utilizes FORCE4 chassis for maximum durability

CHAIN SELECTION CHART

Chain Applications	Saw	Soft Stone/ Abrasive/Brick	Natural Stone	Medium Concrete/ Light Reinforcement	Hard Concrete/ Heavy Reinforcement	Ductile Iron/Cast Iron/PVC/HDPE
TwinMAX™ General Purpose	680GC 695GC		♦	♦		
TwinMAX™ Plus For harder materials	680GC 695GC		♦	♦	♦	
TwinMAX™ Abrasive Ideal for brick & block	680GC 695GC	♦				
TwinPro™ General Purpose	814PRO		♦	♦	♦	
ProFORCE™ General Purpose	890 Series 695F4		♦	♦	♦	
ProFORCE™ L Longer Cutting life	890 Series 695F4		♦	♦	♦	
ProFORCE™ S Faster cutting speed	890 Series 695F4			♦	♦	
ProFORCE™ Abrasive Ideal for brick & block	890 Series 695F4	♦				
PowerGrit For Utility Pipe	890 Series 695F4					♦



Diamond Chain with SealPRO® Technology

Revolutionary SealPRO® Diamond Chain from ICS® is a true design breakthrough that reduces chain stretch by 50% or more, potentially giving you more life out of your diamond chain, even in the most abrasive applications and in situations where water is a premium. SealPro technology is based on a patented design with hundreds of tiny O-rings inserted around every rivet, on every link, sealing out abrasive materials that cause chain stretch.

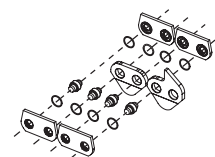

ICS DIAMOND CHAIN



FORCE4® Diamond Chain

From the company that revolutionized concrete saws comes a revolution in diamond chains: FORCE4®. Designed to be the strongest, longest lasting diamond chains ever made, the ProFORCE™ series delivers unrivaled performance in professional cutting applications.

PROFORCE™

Tough general purpose diamond chains that excel in common cutting jobs.

PROFORCE™ PREMIUM L

Delivering longer life in hard aggregate, this is the best choice when faced with the more demanding jobs.

PROFORCE™ PREMIUM S

Speed and strength in one chain. Built to cut fast in medium to hard concrete.

PROFORCE™ ABRASIVE

A heavy duty diamond chain that excels in the harshest cutting environments.



Max Series Diamond Chain

Designed to be used with the full line of ICS gas powered chain saws (except 695F4), these chains offer the ultimate combination of versatility and affordability. Named for the patented double-bumper design, TwinMAX™ chains feature smooth cutting performance and easy installation.

TwinMAX™

A good general purpose chain that will handle 80% of cutting jobs.

TwinMAX™ PLUS

Built to tackle harder materials and more steel, TwinMAX™ Plus is a long-lasting general purpose diamond chain.

TwinMAX™ ABRASIVE

A special diamond concentration and harder bond make this diamond chain perfect for cutting through highly abrasive aggregate like brick and sandstone.

TwinPro™

A great general purpose chain that offers the same easy installation as the TwinMAX™ series, but upgraded diamond segments for serious professional cutting.



PowerGrit Utility Diamond Chain

Utilized by public and private water and wastewater departments worldwide, this patented platform exclusively from ICS is designed to cut a variety of materials from ductile iron to plastic pipe. Featuring a brazed layer diamond coating on our FORCE4 platform, this chain makes your job safer, faster and easier.

ICS ACCESSORIES



Portable Hydraulic Power Pack

ICS® gas operated power packs are a dependable, self-contained source of hydraulic power that offer superior cooling capacity. The functional, ergonomic design makes them easily transportable to any job site.

P95 18 HP (13.5 KW) POWERPACK

Affordable hydraulic power with exceptional cooling capability in an easy to carry package. Adjustable for 5 gpm or 8 gpm (20 lpm or 30 lpm) operation.

P110 23 HP (17 KW) POWERPACK

Step up to the power of the newest addition to the ICS line of reliable powerpacks. Adjustable to 8 gpm or 12 gpm (30 lpm or 45 lpm) operation.

PART NUMBER	DESCRIPTION
550888	P95 18 hp (13.5 kW) Powerpack
555090	P110 23 HP (17 kW) Powerpack

Portable Water Supply

When water isn't readily available, this corrosion resistant poly tank provides the solution. Able to hold up to 25 gallons, this tank offers the required pressure and flow that ICS saws require. The diaphragm High-Flo pump provides 1.8 gpm at 60 psi and comes with molded alligator clips for 12v battery hookup. Comes with a whip fitted with a standard hose end, ready for any regular hose.



PART NUMBER	DESCRIPTION
573285	Portable Water Supply

890F4 Pipe Clamp



In addition to the time saving value of PowerGrit® technology, the pipe clamp accessory developed for the underground pipe application brings a whole new level of safety, accuracy and ease of use to the job. With a simple adaptor, you can mount to this clamp and dramatically reduce the effort of handling the saw, while providing a solid, stable cutting platform that also improves operator safety and the precision of the cut.

PART NUMBER	DESCRIPTION
537640	Pipe Clamp
537634	Axle replacement

Flow Adapter Valve

Enjoy the convenience and efficiency of powering your ICS® hydraulic saw from skid steers, backhoes, and other common construction equipment. Available for both 8 gpm and 12 gpm (30 lpm and 45 lpm) saws.

PART NUMBER	DESCRIPTION
70350	8 gpm Flow adapter valve
71287	12 gpm Flow adapter valve



ICS ACCESSORIES

TSS™ Vacuum Systems

The Total Slurry Solutions™ provide an easy way to contain and dispose of slurry produced when wet-sawing or drilling in concrete, stone, or masonry. All TSS™ systems come with 15 feet (4.6 m) of heavy duty professional grade vacuum hose.

TSS™-15

The TSS™-15 features an extremely durable electric powerhead mounted on a dent and corrosion resistant polyethylene tank. An oversize "boat-plug" style drain plug makes emptying the 15-gallon (55 liter) tank fast and easy and heavy-duty wheels and casters make moving the TSS™-15 effortless.

TSS™ 15/55

Turn any standard 55-gallon drum into a slurry containment system. The TSS™ 15/55 seals to the top with external fasteners or modification, providing 105 inches (267 cm) of water lift.



PART NUMBER	DESCRIPTION
73862	TSS-15 Vacuum system
71285	TSS-55 Vacuum system

SpeedHook®

SpeedHook® is an ingenious accessory designed to support the weight of ICS® hydraulic saws, dramatically reducing operator fatigue and extending chain life.



PART NUMBER	DESCRIPTION
528551	SpeedHook System includes 42 inch (1 m) rail & mounting bracket

ICS® 2-Stroke Oil

Intensive laboratory and field testing have resulted in an oil formula that is cleaner burning, provides better thermal protection and an improved film barrier reducing piston ring wear. Protect your investment with work-proven ICS® 2-stroke Engine Oil.



PART NUMBER	DESCRIPTION
571227	2.6 oz (77 ml) 6-pack
571228	2.6 oz (77 ml) 24-pack

Replacement Parts

Visit your local dealer or see our website icsdiamondtools.com/customer-service-support/ for a complete listing of available parts.



ICS® Large Carry Case

Fits 880, 890 and 853PRO series.

PART NUMBER 505049



ICS PROFORCE DIAMOND BLADES



ProFORCE Asphalt Blades

ICS asphalt blades are some of the best in the industry. Our asphalt blades are designed for extremely long life. Superior undercut protection ensures that your diamond segments will survive in harsh asphalt cutting conditions. The ProFORCE line has a blade for you no matter what size saw you are running.

ProFORCE Green Blades

Built to the same demanding standards as our asphalt blades, our green concrete blades are designed for exceptional life. With reduced undercut protection in order to reduce spalling in the cut. These blades demonstrate a high quality that is noticeable when cutting in abrasive conditions such as green concrete.



ProFORCE Handsaw Blades

ICS handsaw blades are designed to be used in varying applications. Our split segment is designed to retain blade strength while increasing speed. Available in a wide variety of bolt patterns and sizes, ICS handsaw blades are built with versatility in mind.

ProFORCE Cured Blades

Designed to handle the wide variety of concrete cutting situations that professional cutters experience, ICS ProFORCE cured blades are built to the highest of quality standards. With built in undercut protection these blades are designed to last. Whether you are using a low horsepower electric saw or a high horsepower diesel saw we have the blade for you.



ProFORCE WallSaw Blades

ICS wallsaw blades are constructed with a split segment designed to increase cutting speed while also increasing blade core strength. ICS offers wallsaw blades in a .235" thickness, compatible with the width of ICS FORCE4® diamond chains providing enough clearance in the slot to finish corners with the chain saw.

ICS PROFORCE CORE BITS



ProFORCE Core Bits & Accessories

ICS is proud to offer a full line of core bits and core bit accessories. Our robust core bit tubes are built to last and have the ability to be re-tipped multiple times. With sizes ranging from 1/2" to 48" in diameter, the ICS ProFORCE line up of core bits will meet your application.

PROFORCE SB134 CORE BITS

Diameter	1" - 12"
Length	All 14"
Backs	5/8" on all core bits smaller than 1 1/4" 1 1/4" on all core bits 1 1/4" larger
Segments	All core bits smaller than 1 1/4" utilize crowns All core bits larger than 1 1/4" utilize traditional segments

CORE BIT ACCESSORIES

Core Bit Adapter	4 x 1.250 - 7 to 5/8-11
Core Bit Extension	4 x 1.250-7
Core Bit Extension	6 x 1.250-7
Core Bit Extension	6 x 5/8-11
Core Bit Extension	12 x 1.250-7
Core Bit Extension	12 x 5/8-11

PROFORCE PLUS SB134 CORE BITS

Diameter	1/2" - 48"
Length	14" length on all core bits 12" diameter and smaller 18" length on 14" diameter core bit 20" length on 16" diameter core bit 22" length on 18" diameter core bit 24" length on all core bits 20" in diameter and larger
Backs	5/8" on all core bits smaller than 1 1/4" 1 1/4" on all core bits 1 1/4" and larger All backs 12" and smaller are welded on Bolt on ultra-light backs for core bits 14" and larger
Segments	All core bits smaller than 1 1/4" utilize crowns All core bits larger than 1 1/4" utilize traditional segments Pre-stressed concrete core bits available in sizes 1/2" - 12"



ICS DIAMOND WIRE

Continuing the tradition of providing products with the highest level of quality and performance available, ICS is proud to offer the next generation of diamond wire, specifically designed for the applications of cutting concrete, concrete with reinforcement and steel. ICS diamond wire is manufactured in a state-of-the-art facility with precision specifications to deliver the best in service, economy and performance.

Electroplated Wire

The ICS electroplated diamond wire offering provides several options for economically cutting a wide range of materials from reinforced concrete to pure steel. The proprietary design efficiently uses diamonds that are tuned for each unique application, allowing you to optimize your wire sawing operations.

HEAVY CONCRETE WIRE - P/N 571316 / 571347

ELECTROPLATED, REINFORCED CONCRETE



STEEL WIRE - P/N 571317 / 571348

ELECTROPLATED, PURE STEEL (fast cutting)



STEEL WIRE - P/N 571318 / 571359

ELECTROPLATED, PURE STEEL (longer lasting)



FINISH WIRE - P/N 571319 / 571360

ELECTROPLATED, CONCRETE OR PURE STEEL (rescue wire)



Sintered Wire

ICS sintered Super Wire provides a proven and economical way to cut fast in concrete and concrete with light steel. Designed to provide smooth operation and extremely efficient use of the diamonds, ICS Super Wire saves you time and money, and gets you on to the next job quickly.

SUPER WIRE - P/N 571315 / 571346

SINTERED, CONCRETE STRUCTURES



P/N	ICS Specs	Type	Length	Wet Cut	Dry Cut	Wire Speed (m/s)	Max Wire Tension (kg/ft)	Max Temp (dry saw)	Beads/ Meter	Bead Diameter (mm)	Bead Width (mm)	Bead to Bead separation (mm)	Cable Diameter (mm)
571315	S14	Sintered	50 ft	Yes	Yes	22	300	100° C	40	11	6.5	25	4.8
571346	S14	Sintered	100 ft	Yes	Yes	22	300	100° C	40	11	6.5	25	4.8
571316	E1	Electroplated	50 ft	Yes	Yes	22	300	100° C	40	10.2	5.5	25	4.8
571347	E1	Electroplated	100 ft	Yes	Yes	22	300	100° C	40	10.2	5.5	25	4.8
571317	E2	Electroplated	50 ft	Yes	Yes	22	300	100° C	40	10.8	5.5	25	4.8
571348	E2	Electroplated	100 ft	Yes	Yes	22	300	100° C	40	10.8	5.5	25	4.8
571318	E4	Electroplated	50 ft	Yes	Yes	22	300	100° C	48	10.8	5.5	20.8	4.8
571359	E4	Electroplated	100 ft	Yes	Yes	22	300	100° C	48	10.8	5.5	20.8	4.8
571319	E5	Electroplated	50 ft	Yes	Yes	22	300	100° C	40	8.8	5.5	25	4.8
571360	E5	Electroplated	100 ft	Yes	Yes	22	300	100° C	40	8.8	5.5	25	4.8

CONNECTORS & ACCESSORIES

Connectors



P/N	ICS Specs	TYPE	PACKAGE SIZE (pcs.)	OUTER DIAMETER (mm)	INNER DIAMETER SLEEVE (mm)	LENGTH OF SLEEVE (mm)
571262	PF1	Straight	30 pcs.	9.2	5.3	20
571263	PF3	Flexible	5 pcs	9.4	5.2	33
571264	PF4	Screw	20 pcs	9.0	5.3	25
571265	PF7	Flexible	5 pcs	9.5	5.2	28

Accessories



P/N	ICS SPECS	TYPE
571266	PF8	Die
571267	PF45	Press (5 tons)
571268	PF6	Pin Remover

**WORKS WITH PENTRUDE
WIRE SAW P. 27**



Precision. Perfected.

The difference is in the details.

8-20HF Wall Saw
Machined Aluminum Frame

Pentrunder products provide the most powerful cutting, sawing, and drilling solutions for unparalleled productivity. Pentrunder users make the straightest lines and openings in the toughest materials because Pentrunder tools feature rigid construction, finely tuned motors, and countless construction details. If you are using a Pentrunder product now, you know how much more you can do in a day. If you have not yet tried Pentrunder, do you know what you're missing?

SOLUTIONS FOR CONCRETE, MASONRY, STONE

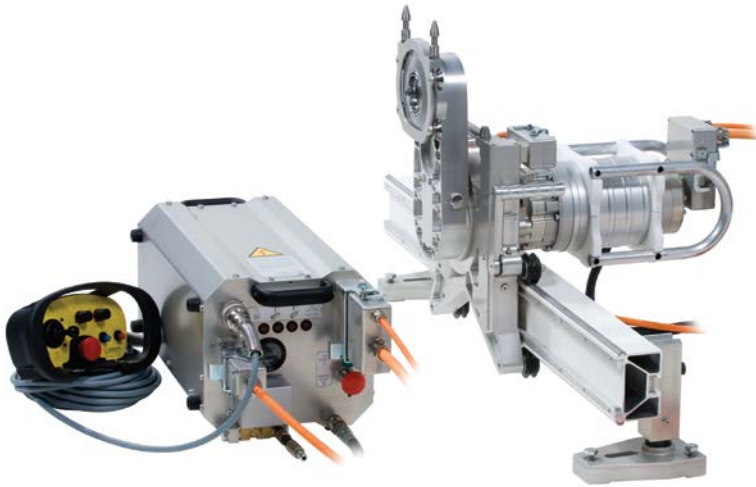

FEATURES AND BENEFITS

- Most popular Pentruder saw
- Powerful - cut up to 36 inches deep in concrete
- Precise because of rigid aluminum construction
- Portable with each component less than 60lbs



8-20 HF Wall Saw

With its high performance HF-motor and the quick disconnect blade coupling, the Pentruder 8-20 HF Wall Saw does the most demanding jobs more efficiently. Thanks to the 4-speed gearbox, this saw will work with remarkably high torque at all spindle speeds. Engineered to deliver dependable, lightweight, reliable power, this saw is ideal for anyone who is a professional cutter.

TECHNICAL SPECIFICATIONS

Maximum blade diameter	79 inches
Maximum cutting depth	36 inches
Maximum out-of-cut diameter	39 inches
Saw blade motor (30 HP HF-motor)	400 Hz High Frequency Motor
Max continuous output power	30 HP with Pentpak 427
Spindle speed under load	1st gear: 350 - 510 rpm 2nd gear: 500 - 735 rpm 3rd gear: 630 - 925 rpm 4th gear: 790 - 1165 rpm, @ 300 - 440 Hz
Saw head weight	56 lbs
Weight (30 HP HF-motor)	40 lbs

8-20HF Wall Saw
4-speed Gear Box



High torque at all spindle speeds because of 4-speed gearbox and software controls

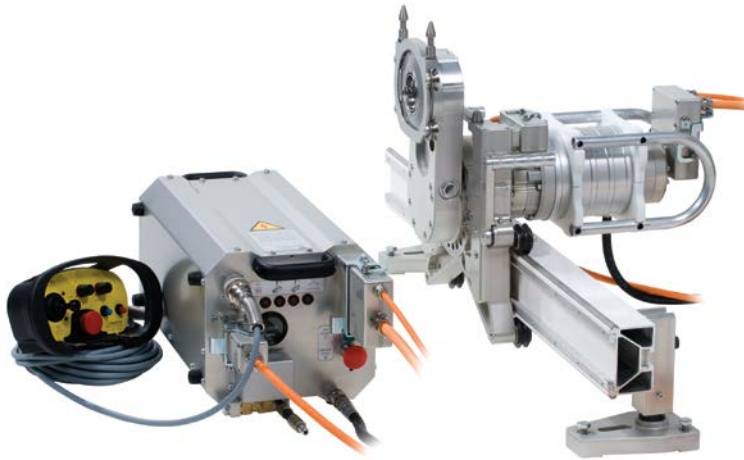

FEATURES AND BENEFITS

- Powerful - cuts up to 28 inches deep in concrete & rebar
- Precise because of aluminum construction
- Portable with each component less than 60 lbs

CBK HF Wall Saw

With its high performance HF-motor and the quick disconnect blade coupling, the Pentruder CBK is an extremely user-friendly saw. The spindle speed is electronically varied with the potentiometer and the saw handles blades up to 63". This saw offers a combination of easy handling and a good power-to-weight ratio.

TECHNICAL SPECIFICATIONS

Maximum blade diameter	63 inches
Maximum cutting depth	28 inches
Maximum out-of-cut diameter	36 inches
Saw blade motor (30 HP HF-motor)	400 Hz High Frequency Motor
Max continuous output power	30 HP with Pentpak 427
Spindle speed under load	600 - 1000 rpm @ 300-500 Hz *
Saw head weight	54 lbs
Weight (30 HP HF-motor)	40 lbs

*continuously variable from 70 - 100% set potentiometer to control speed



SOLUTIONS FOR CONCRETE, MASONRY, STONE

3P8 HF Wire Saw

The Pentruder 3P8 wire saw offers extraordinary performance and virtually unlimited sawing depths. The electric automatic feed not only makes the start of the wire simple, but it extends the lifetime of the wire. With a quick and easy setup, thanks to the modular, low weight design, this saw is suitable for both small and large jobs.

**DIAMOND WIRE AVAILABLE IN 50' & 100' LENGTHS.
SEE PAGES 22-23 FOR DETAILS**



FEATURES AND BENEFITS

- Easily control wire tension and slack with tensioning wheel and automatic wire feed.
- Start cuts quickly with high torque, slip resistant system.

TECHNICAL SPECIFICATIONS

Drive motor power	400 Hz High Frequency Motor
Max continuous output power	25 HP
Storage in rollers	21 feet
Storage capacity	8 feet of wire pulled in for each
1 foot travel of the carriage	30 HP with Pentpak 427
Maximum approx. 65 feet	1st gear: 350 - 510 rpm
Main drive pulley diameter	20 inches
Storage pulleys diameter	8 inches O.D.



FREQUENTLY ASKED QUESTIONS

When do I need to replace a chain?

When the diamond segment has worn down to the welded pad on the chain chassis. Typically a chain will cut 40 – 80 linear feet in 6 inch concrete. On ICS hydraulic saw, this range is most often doubled.



Worn ProFORCE chain



Worn PowerGRIT chain

Can a concrete or utility saw cut dry or without connected pressurized water through the saw?

No. ICS saws require 20 psi/1 gpm (1.5 bar) minimum. To check for water pressure without a pressure gauge, attach water hose to the saw water connection. Pull the chain off to one side of the bar and turn on water valve. If there is a minimum of 20 psi, water should optimally spray 1.5 to 3 feet above the bar.

What is the proper Chain Tension?

All chains have a tendency to stretch when used. Diamond chains stretch more than wood cutting chains because of the abrasive materials they cut. If the chain is too tight, a lot of the saw's power goes into turning the chain rather than the cut. In extreme over-tightened cases, the saw may not be able to turn the chain at all. In addition, damage can occur to the bar nose and premature stretch may occur.

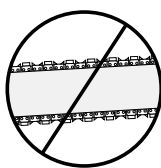
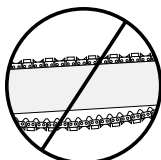
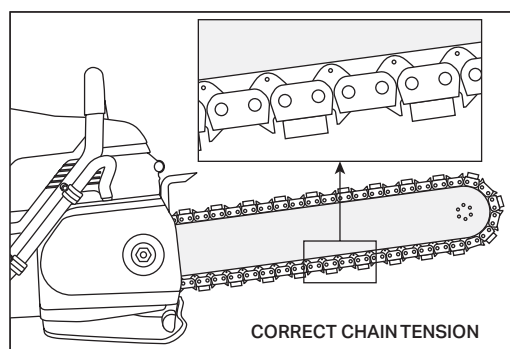

If the chain is too loose, it could come off the bar, or it will allow the drive sprocket to spin without turning the chain, which can chew up drive links. When a chain stretches to a point where the drive links are hanging approximately 1/2 in. (12 mm) to 3/4 in. (18 mm) below the bar, it is time to tension the chain.

See ICS training videos for saw setup

How do I maximize the life of my Guidebar?

To extend guidebar life, flip guidebar top to bottom when installing a new chain. A guide bar has reached end of life under normal use after 2 - 3 chains.

When do I need to replace my drive sprocket?

Drive sprockets need to be replaced when the groove has worn 50% of the way through the top of the sprocket tooth. A rule of thumb for ICS gas saws is every 2-4 chains and for ICS hydraulic saws, every 7-9 chains (depending on chain chassis).

HYDRAULIC



NEW → REPLACE

GAS



NEW → REPLACE

Can a diamond chain cut rebar?

Yes, number 4 or 5 (12 or 16 mm) bar is not a problem. Anything over number 8 (25mm) is difficult. Large amounts of rebar will reduce chain life. Caution: rebar must be surrounded by concrete or aggregate material.

Will PowerGrit cut steel?

PowerGrit utility chain is designed to cut ductile iron pipe, cast iron pipe, HDPE and PVC.

What is the mixture ratio of Fuel to Oil

Consult your operator manual for the proper fuel to oil mix recommendation.

Where do I go for more training tips or information?

icsdiamondtools.com/pro-corner

When do I replace my air filter?

When it is either wet or dirty. Some examples are: if the saw is underperforming or acting sluggish.

What steps should I take daily to maintain my saw?

After each use, rinse the saw, bar and chain with water. Inspect all fasteners, sprocket, starter rope and air filter for wear. Oil the guidebar, diamond chain and bar nose sprocket and grease the chain tensioner.

Does ICS have a tool that cuts underwater?

The ICS hydraulic chain saw line can be fully submersed.

Can I use ICS saws in freezing or below freezing temperatures?

There are biodegradable additives available that can be added to your water supply. Contact your regulatory agency for specific details.

For additional information, please visit icsdiamondtools.com.

NEW AND IMPROVED WEBSITE

1. Success Stories: highlight existing user job challenges and ultimate successes
2. Pro Corner Page: provides step-by-step guides, instructional videos and guides to help you get the most out of your ICS products
3. Product images and definitions to easily navigate to desired pages
4. Responsive design - site is built in a way to ensure proper display of and access to content across the range of common devices (phone, tablet, laptop, etc.)
5. Link to dealer locator in prominent positions allows instant access to dealer network information
6. User-friendly homepage with scrolling images and links
7. Links to all pages along the bottom gives the option to scroll through individual page selection with ease
8. Links to parts lists, operator manuals and technical information

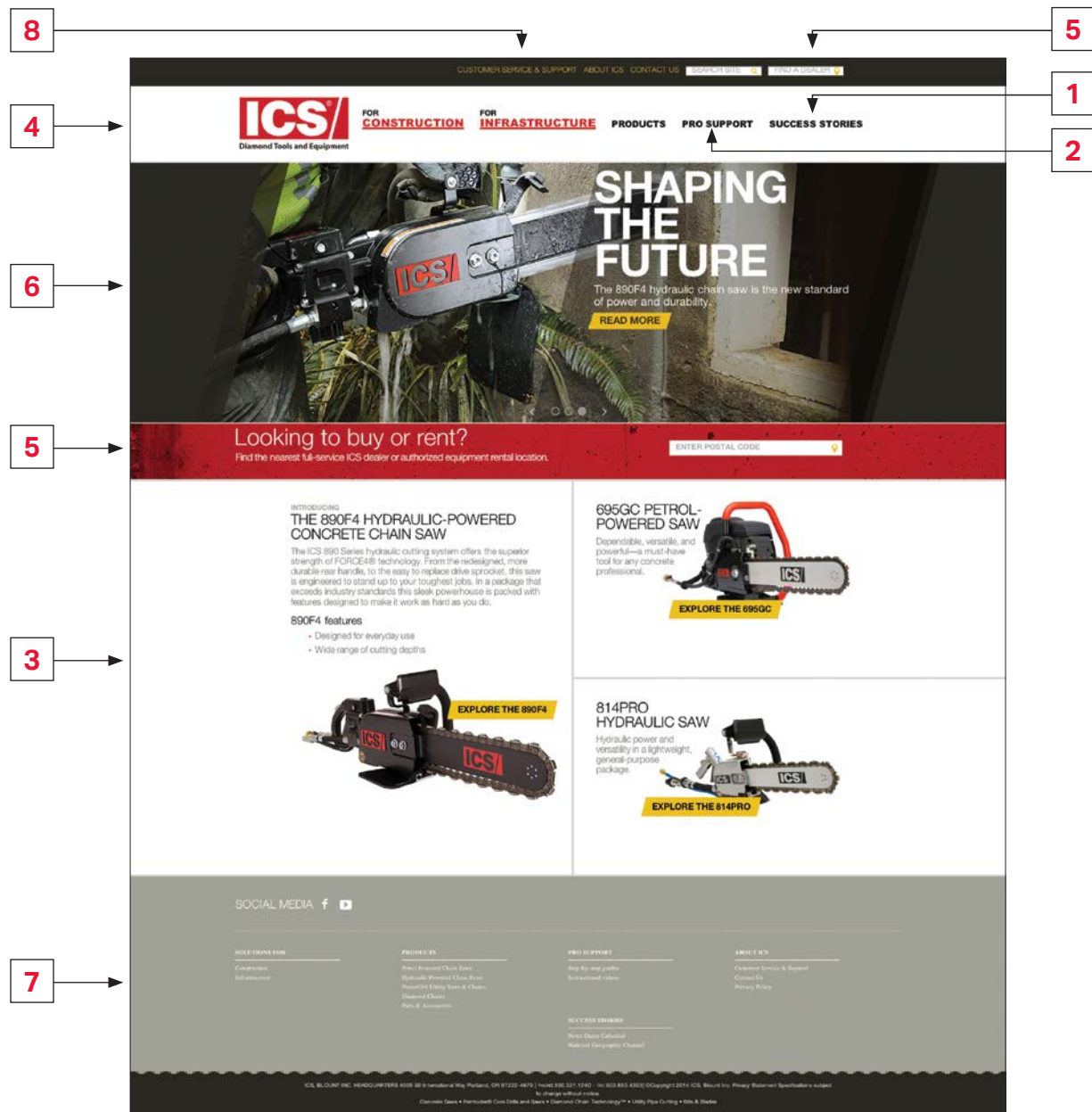

PART NUMBERS

695GC GAS SAWS AND CONSUMABLES

PART NUMBER	DESCRIPTION
544106	ICS 695GC Powerhead
553464	ICS 695GC-12 Gas Saw Package, with 12 inch Guidebar & TwinMAX Chain
544107	ICS 695GC-14 Gas Saw Package, with 14 inch Guidebar & TwinMAX Chain
544108	ICS 695GC-16 Gas Saw Package, with 16 inch Guidebar & TwinMAX Chain
71400	ICS TwinMAX-29 chain 12 inch
71486	ICS TwinMAX-32 chain 14 inch
71607	ICS TwinMAX-35 chain 16 inch
71704	ICS TwinMAX-29 Plus chain 12 inch
71705	ICS TwinMAX-32 Plus chain 14 inch
71706	ICS TwinMAX-35 Plus chain 16 inch
71554	ICS TwinMAX-29 Abrasive chain 12 inch
71610	ICS TwinMAX-32 Abrasive chain 14 inch
71611	ICS TwinMAX-35 Abrasive chain 16 inch
553207	ICS 695GC Guidebar 12 inch
73600	ICS 695GC Guidebar 14 inch
71600	ICS 695GC Guidebar 16 inch
70949	ICS 695GC Drive Sprocket

695F4 GAS SAWS AND CONSUMABLES

PART NUMBER	DESCRIPTION
545089	ICS 695F4 Powerhead
553463	ICS 695F4-12 Gas Saw Package, with 12 inch FORCE4 Guidebar & ProFORCE Chain
546804	ICS 695F4-16 Gas Saw Package with 16 inch FORCE4 Guidebar & ProFORCE Chain
545018	ICS 695PG-16 Gas Saw Package with 16 inch FORCE4 Guidebar & PowerGrit Chain
531743	ICS ProFORCE-25 chain 10/12 inch
525342	ICS ProFORCE-29 chain 15/16 inch
531745	ICS ProFORCE-25 Premium L chain 10/12 inch
525343	ICS ProFORCE-29 Premium L chain 15/16 inch
531739	ICS ProFORCE-25 Premium S chain 10/12 inch
531735	ICS ProFORCE-29 Premium S chain 15/16 inch
531747	ICS ProFORCE-25 Abrasive chain 10/12 inch
525344	ICS ProFORCE-29 Abrasive chain 15/16 inch
537764	ICS PowerGrit Chain 16 inch
553208	ICS 695F4 Guidebar 12 inch
524490	ICS 695F4 Guidebar 16 inch
525496	ICS 695F4 Drive Sprocket

680GC GAS SAWS AND CONSUMABLES

PART NUMBER	DESCRIPTION
545090	ICS 680GC Powerhead
545058	ICS 680GC-12 Gas Saw Package, with 12 inch Guidebar & TwinMax Chain
545099	ICS 680GC-14 Gas Saw Package, with 14 inch Guidebar & TwinMax Chain
71400	ICS TwinMAX-29 chain 12 inch
71486	ICS TwinMAX-32 chain 14 inch
71704	ICS TwinMAX-29 Plus chain 12 inch
71705	ICS TwinMAX-32 Plus chain 14 inch
71554	ICS TwinMAX-29 Abrasive chain 12 inch
71610	ICS TwinMAX-32 Abrasive chain 14 inch
71395	ICS 680GC Guidebar 12 inch
513122	ICS 680GC Guidebar 14 inch
70949	ICS 680GC Drive Sprocket

814PRO HYDRAULIC SAWS AND CONSUMABLES

PART NUMBER	DESCRIPTION
75256	ICS 814PRO Powerhead 8 gpm
71675	ICS 814PRO Saw Package 8 gpm with 13 inch Guidebar & TwinPRO Diamond Chain
74719	ICS TwinPRO-25 chain 13 inch
74042	ICS t Guidebar 13 inch
71385	ICS 814PRO Drive Sprocket

890F4 HYDRAULIC SAWS AND CONSUMABLES

PART NUMBER	DESCRIPTION
566110	ICS 890F4 Powerhead 8 gpm, 1 ft hose whips
566355	ICS 890F4 Powerhead 8 gpm, 8 ft hose whips
566112	ICS 890F4 Powerhead 12 gpm, 1 ft hose whips
566116	ICS 890F4 Powerhead 12 gpm, 8 ft hose whips
566113	ICS 890F4-FLUSH Powerhead 8 gpm, 1 ft hose whips
566351	ICS 890F4-FLUSH Powerhead 8 gpm, 8 ft hose whips
566114	ICS 890F4-FLUSH Powerhead 12 gpm, 1 ft hose whips
566117	ICS 890F4-FLUSH Powerhead 12 gpm, 8 ft hose whips
566127	ICS 890F4-15 Saw Package 8 gpm with 15 inch Guidebar, ProFORCE chain, 1 ft hose whips, case
566717	ICS 890F4-15 Saw Package 8 gpm with 15 inch Guidebar, ProFORCE chain, 8 ft hose whips, case

PART NUMBERS

566123	ICS 890PG-15 Saw Package 8 gpm, 15 inch Guidebar, PowerGrit chain, 1 ft hose whips, case
566710	ICS 890PG-15 Saw Package 8 gpm, 15 inch Guidebar, PowerGrit chain, 8 ft hose whips, case
566125	ICS 890PG-15 Saw Package 12 gpm, 15 inch Guidebar, PowerGrit chain, 1 ft hose whips, case
566712	ICS 890PG-15 Saw Package 12 gpm, 15 inch Guidebar, PowerGrit chain, 8 ft hose whips, case
566124	ICS 890PG-20 Saw Package 8 gpm, 20 inch Guidebar, PowerGrit chain, 1 ft hose whips, case
566711	ICS 890PG-20 Saw Package 8 gpm, 20 inch Guidebar, PowerGrit chain, 8 ft hose whips, case
566126	ICS 890PG-20 Saw Package 12 gpm, 20 inch Guidebar, PowerGrit chain, 1 ft hose whips, case
566716	ICS 890PG-20 Saw Package 12 gpm, 20 inch Guidebar, PowerGrit chain, 8 ft hose whips, case
529829	ICS 890F4 Guidebar 10 inch
523080	ICS 890F4 Guidebar 15 inch
529767	ICS 890F4 Guidebar 20 inch
525320	ICS 890F4 Guidebar 25 inch
531743	ICS ProFORCE-25 chain 10/12 inch
525342	ICS ProFORCE-29 chain 15/16 inch
531749	ICS ProFORCE-34 chain 20 inch
525345	ICS ProFORCE-40 chain 25 inch
531745	ICS ProFORCE-25 Premium L chain 10/12 inch
525343	ICS ProFORCE-29 Premium L chain 15/16 inch
531751	ICS ProFORCE-34 Premium L chain 20 inch
525346	ICS ProFORCE-40 Premium L chain 25 inch
531739	ICS ProFORCE-25 Premium S chain 10/12 inch
531735	ICS ProFORCE-29 Premium S chain 15/16 inch
531741	ICS ProFORCE-34 Premium S chain 20 inch
531737	ICS ProFORCE-40 Premium S chain 25 inch
531747	ICS ProFORCE-25 Abrasive chain 10/12 inch
525344	ICS ProFORCE-29 Abrasive chain 15/16 inch
531753	ICS ProFORCE-34 Abrasive chain 20 inch
525347	ICS ProFORCE-40 Abrasive chain 25 inch
537764	ICS PowerGrit Chain 15 inch
537765	ICS PowerGrit Chain 20 inch

545017	ICS PowerGrit Chain 25 inch
565065	ICS 890F4 Drive Sprocket
565066	ICS 890F4-FLUSH Drive Sprocket

701-A PNEUMATIC SAW AND CONSUMABLES

PART NUMBER	DESCRIPTION
573511	ICS 701-A Powerhead
574173	ICS 701-A Saw Package with 15" Guidebar and ProFORCE Chain
574171	ICS 701-A Saw Package with 15" Guidebar and PowerGrit Chain
574172	ICS 701-A Saw Package with 20" Guidebar and PowerGrit Chain
523080	ICS 890F4 Guidebar 15 inch
529767	ICS 890F4 Guidebar 20 inch
525320	ICS 890F4 Guidebar 25 inch
525342	ICS ProFORCE-29 chain 15/16 inch
531749	ICS ProFORCE-34 chain 20 inch
525345	ICS ProFORCE-40 chain 25 inch
525343	ICS ProFORCE-29 Premium L chain 15/16 inch
531751	ICS ProFORCE-34 Premium L chain 20 inch
525346	ICS ProFORCE-40 Premium L chain 25 inch
531735	ICS ProFORCE-29 Premium S chain 15/16 inch
531741	ICS ProFORCE-34 Premium S chain 20 inch
531737	ICS ProFORCE-40 Premium S chain 25 inch
525344	ICS ProFORCE-29 Abrasive chain 15/16 inch
531753	ICS ProFORCE-34 Abrasive chain 20 inch
525347	ICS ProFORCE-40 Abrasive chain 25 inch
537764	ICS PowerGrit Chain 15 inch
537765	ICS PowerGrit Chain 20 inch
545017	ICS PowerGrit Chain 25 inch



Diamond Tools and Equipment



ICS | Blount, Inc
4909 SE International Way • Portland OR 97222 • USA
T 800.321.1240 • F 503.653.4393